

## Material Handling Equipment

Pfaff-silberblau industrial trucks are ideal for transporting and stacking loads on pallets in factories.

The comprehensive range of products offers the correct model for numerous applications; be it for different route lengths or degrees of utilization, gradients and ramps or areas with a corrosion hazard.

From pallet trucks, manual stackers to electric stackers and elevating platforms – you will find the appropriate solution.

## Load Moving Systems

Yale heavy load moving systems for the safe transportation of heavy loads of up to 100t.

Products range from separately used load moving skates to complete systems.

## INFO

---

Please note our user instructions at the beginning of each chapter.

## Table of contents

	Page
<b>Hand pallet trucks</b>	<b>274 - 283</b>
<b>Hand pallet trucks with weighing system</b>	<b>284 - 285</b>
<b>Scissor pallet trucks</b>	<b>286 - 287</b>
<b>Electric pallet trucks</b>	<b>288 - 293</b>
<b>Manual drive stackers</b>	<b>294 - 301</b>
<b>Electric pedestrian stackers</b>	<b>302 - 310</b>
<b>Elevating platforms</b>	<b>311 - 321</b>
<b>Load Moving Systems</b>	<b>322 - 327</b>

# PFAFF

*silberblau*

## MATERIAL HANDLING EQUIPMENT



# OPERATION

**This user information presents a general review regarding the application of material handling equipment and does not substitute the existing operating instructions for specific industrial trucks and elevating platforms!**

**Operating industrial trucks as well as lifting operations must be carried out by competent persons. When operated correctly, our products will offer the highest degree of safety, avoid damage to products and people and present a long life expectancy.**

## Modification of delivery condition

Design and construction of material handling products must not be altered by e.g. assembly of outside supplied components, bending, welding, grinding, cutting-off parts, adding boreholes, removal of safety devices or fitting of attachments.

## Limitations of operation

### Loading

The rated capacity (WLL) indicated on the product is the maximum load which must not be exceeded.

### Transport of people

Transport of people with industrial trucks is generally forbidden!

### Operation in danger zones

Lifting or transport of loads must be avoided while personnel are in the danger zone.

Do not allow people to stay on or below a raised load.

Do not place hands or feet under the raised fork frame or load on account of the imminent danger of crushing or shearing.

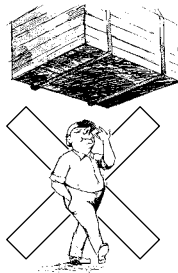

## Inspection before starting work

- Prior to starting work, the unit must be inspected for obvious deficiencies and failures. Operational checks must be performed to ensure lifting, lowering and travel operate correctly.
- Check the parking brake is effective and the key switch operates correctly to protect against unauthorised use.
- Load carriage and forks must not show obvious defects (deflections, cracks or other wearing).
- Wheels and tires must not be defective.
- The hydraulic system must be in perfect order (lifting, lowering, density).
- The functional capability of the collision protective device should be checked.
- Battery charging status, fastening and cable connections of the battery as well as battery plug must be inspected for appropriate status as well as the battery cell lids (dry, clean).

## Application advices

- Our material handling equipment must be operated on in-plant areas only.
- Only use industrial trucks in perfect condition and with legible identity plate.
- Industrial trucks may only be operated by skilled people, who have been instructed (in theory and practice) by the responsible user.
- The travel speed must conform to local conditions.
- Industrial trucks must be operated on flat, level and even ground.
- The operator must make sure that the load unit is in perfect condition and safely attached.
- Pallets may be transported individually only.
- Industrial trucks must not be used as car jacks.
- Industrial trucks must not be used in areas which are not illuminated sufficiently.
- Forks may not be used as levers.
- Loading of just one fork, e.g. for lifting of a machine, is strictly forbidden.
- Industrial trucks may not be operated in direct contact with foodstuffs.
- Never turn the hand lever 90° in order to stop the truck.
- The industrial truck must not be operated in explosive atmospheres (special versions on request).

## Maintenance and repair

- To ensure safe operation, all material handling equipment must be subjected to regular inspections according to the maintenance instructions provided by the manufacturer.
- Material handling equipment, which is due for maintenance normally at least once per year, unless adverse working conditions dictate shorter periods.
- Inspections and repairs must be performed by competent persons or specialist workshops that use original spare parts. Inspections and repairs have to be recorded consecutively.

## Inspections

- Inspections are visual and functional and shall establish that the product has not been damaged by incorrect transport or storage. In addition check for damage, wear, corrosion or other deficiencies as well as completeness and function safety devices. Inspections are instigated by the user.
- Material handling products have to be cleaned prior to inspection. The cleaning procedure must not cause chemical damages (e.g. no acid – embrittlement) no incorrect temperature stress by e.g. flame cleaning or possible concealment of cracks due to excessive material abrasion (sand blasting).  
We shall be pleased to consult you in this respect!
- **Inspection of fork frame**  
The fork frame has to be checked regularly for obvious defects, deformations and cracks as well as wear and corrosion.
- **Inspection of control handle**  
The control handle must be checked regularly for obvious defects, deformations, cracks. Moreover, check screws for fixed seat.
- **Inspection of oil level**  
Check oil level every six months (oil viscosity 30 Cst at 40 °C). At ambient temperature around 0 °C we recommend AVILUB RSL 22.
- **Inspection of lubrication and density**  
Bolts, axles and push rods should be cleaned and lubricated depending on application with e.g. Shell FD or comparable grease.
- The hydraulic unit has to be checked regularly for density.





Load diagrams  
for residual carrying capacities

**EHH PSE 10-30**

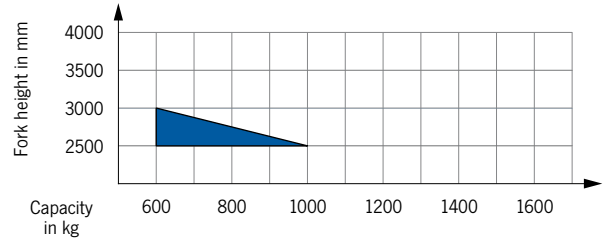

**EHH PS 12-25/12-29/12-35**

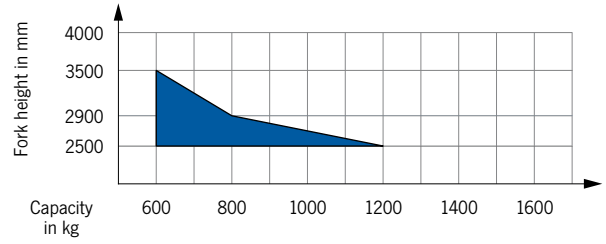

**EGV PSL 12-25 II/12-29 II/12-35 II**

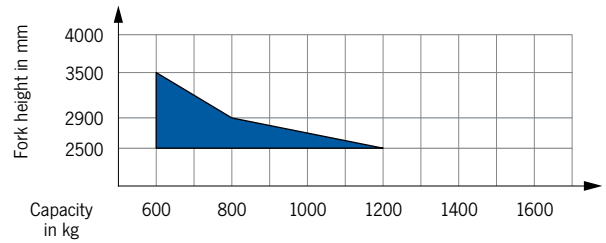

**EGV PSH 14-45 TII/14-45 TFII**

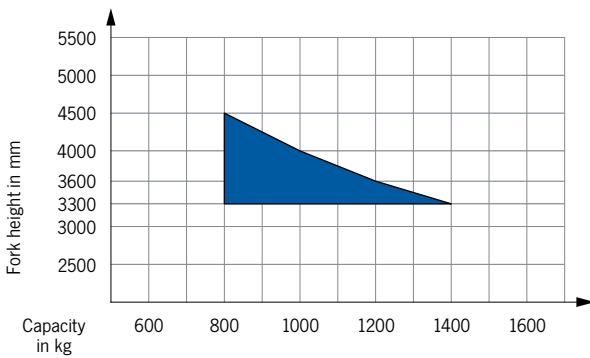

**EGV PSH 14-50 TII**

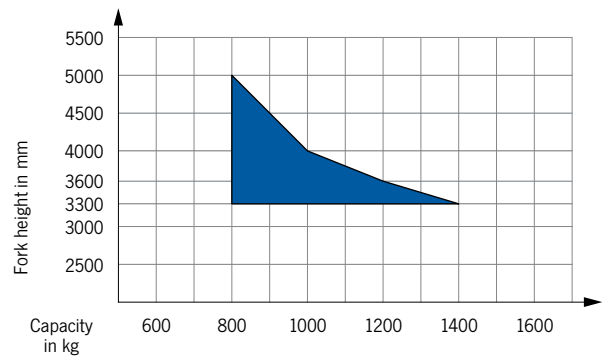

**EGV PSH 12-25 II/12-29 II/12-35 II**

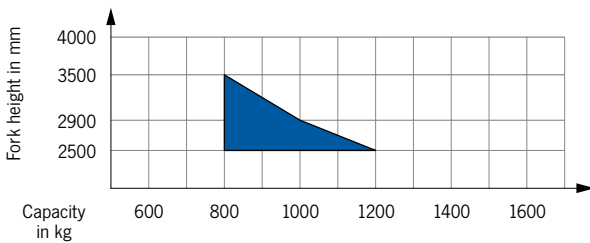

**EGV PSH 16-25 II/16-29 II/16-35 II**

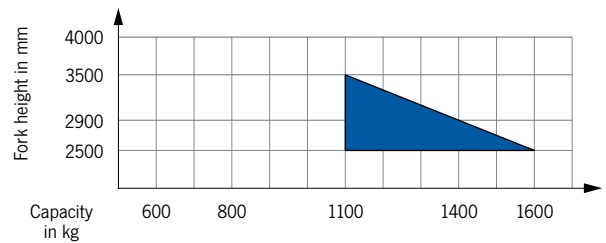

## Technical questionnaire to identify a suitable material handling product

Company: \_\_\_\_\_ Date: \_\_\_\_\_

Contact: \_\_\_\_\_ e-Mail: \_\_\_\_\_

Phone: \_\_\_\_\_ Fax: \_\_\_\_\_

Capacity \_\_\_\_\_ kg  
Fork height max. \_\_\_\_\_ mm  
Freelift \_\_\_\_\_ mm  
Required residual lifting  
capacity \_\_\_\_\_ mm  
At fork height \_\_\_\_\_ mm  
Headroom with mast retracted \_\_\_\_\_ mm

### Lifting

- manual-hydraulic
- electric-hydraulic

### Drive

- manual
- electric

### Transport and stacking of:

- palletised goods
- long goods
- loading lorries

Special requests

\_\_\_\_\_  
\_\_\_\_\_

### Lengths of application per shift

- up to 2 hours
- up to 4 hours
- up to 6 hours
- up to 8 hours

Shifts per day

\_\_\_\_\_

### Drivers platform

- yes
- no





**HU 25-115 TS SILVERLINE**  
Hand pallet truck  
(Tandem rollers)

**HU 25-115 ES SILVERLINE**  
Hand pallet truck  
(Single rollers)

Capacity 2500 kg

For the professional transportation of palletised goods and box pallets under demanding conditions.

**Features**

- Ergonomic safety control handle for one-hand operation of lifting, driving and lowering.
- Ergonomic rubber control handle for safe handling.
- Low maintenance hydraulic pump with hard chromium plated piston.
- Frame and forks in robust steel construction, adjustable connecting rods, especially hardened axles and the high quality powder coating ensure a long life expectancy.



Option: Parking brake

**Technical data HU 25-115 TS SILVERLINE and HU 25-115 ES SILVERLINE**

Model	HU 25-115 TS	HU 25-115 TS	HU 25-115 TS	HU 25-115 TS	HU 25-115 TS	HU 25-115 ES
Art.-No.	N21225460	N21225461	N21225462	N21225463	N21225464	N21225220
Capacity, kg	2500	2500	2500	2500	2500	2500
Load center c, mm	600	600	600	600	600	600
Weight, kg	70	68	69	65	70	67
Tyre type <sup>1</sup>	VG/PA	VG/PUR	PUR/PUR	PA/PA	PUR/PA	VG/PUR
Steering rollers, mm	200 x 50	200 x 50	200 x 50	200 x 50	200 x 50	200 x 50
Load rollers, mm	80 x 70	80 x 70	80 x 70	80 x 70	80 x 70	80 x 93
Number of wheels/load rollers	2/4	2/4	2/4	2/4	2/4	2/2
Stroke h3, mm	115	115	115	115	115	115
Height of control handle h14, mm	1230	1230	1230	1230	1230	1230
Fork height lowered h13, mm	85	85	85	85	85	85
Overall length L1, mm	1555	1555	1555	1555	1555	1555
Fork height s, mm	48	48	48	48	48	48
Fork width e, mm	160	160	160	160	160	160
Fork length l, mm	1150	1150	1150	1150	1150	1150
Outside dimension of forks b1, mm	540	540	540	540	540	540
Inside dimension of forks b3, mm	220	220	220	220	220	220
Ground clearance m1, mm	37	37	37	37	37	37
Aisle width pallet Ast, mm	1793	1793	1793	1793	1793	1793
Turning circle radius Wa, mm	1275	1275	1275	1275	1275	1275

<sup>1</sup>PA... Polyamide, PUR... Polyurethane, VG... Solid rubber

## HU 20-115 VATP PROLINE Hand pallet truck stainless steel version

Capacity 2000 kg

For the professional transportation of palletised goods in corrosive areas.

### Features

- Ergonomic safety control handle for one-hand operation of lifting, driving and lowering.
- Low maintenance high performance hydraulic pump with hard chromium plated piston and pressure relief valve. Hydraulic unit made of stainless steel resp. bronze (HU 25-115 VATP).
- Frame, adjustable connecting rods, bolts and the torsion tube are made of high quality stainless steel.
- Steering angle of 105 degree to each side for easy handling in confined spaces.



## INFO

The operator is responsible for an analysis of the working conditions in order to assess the suitability of the hand pallet truck.

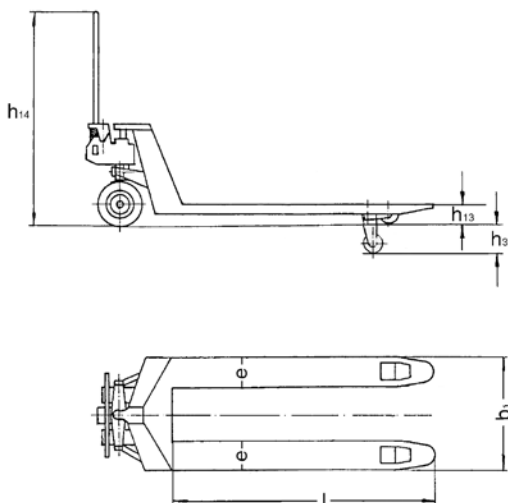

### Technical data HU stainless steel version

Model	HU 20-115 VATP
Art.-No.	40005740
Material	V4A/316
Capacity, kg	2000
Weight, kg	86
Tyre type <sup>1</sup>	PA/PA
Steering rollers, mm	200 x 50
Load rollers, mm	82 x 70
Stroke h3, mm	115
Height of control handle h14, mm	1200
Fork height lowered h13, mm	85
Fork width e, mm	160
Fork length l, mm	1150
Outside dimension of forks b1, mm	540

<sup>1</sup>PA... Polyamide





**Hand pallet truck SILVERLINE with a smaller or a wider loading width**

**Capacity 1500 - 2500 kg**

For the professional transportation of special pallets, e.g. brickyard pallets or american pallets.

**Features**

- Ergonomic safety control handle for one-hand operation of lifting, driving and lowering.
- Ergonomic rubber control handle for safe handling.
- Low maintenance high performance hydraulic pump with hard chromium plated piston and pressure relief valve.
- Frame and forks in robust steel construction, adjustable connecting rods, especially hardened axles and the high quality powder coating ensure a long life expectancy.
- Steering angle of 105 degree to each side for easy handling in confined spaces.



Option: Parking brake

**Technical data hand pallet truck SILVERLINE**

Model	HU 15-115 TP	HU 20-115 BTS	HU 25-115 BTS
Art.-No.	40006498	34527132	N21225457
Capacity, kg	1500	2000	2500
Weight, kg	80	86	73
Tyre type <sup>1</sup>	PUR/PUR	VG/PUR	VG/PUR
Steering rollers, mm	200 x 50	200 x 50	200 x 50
Load rollers, mm	82 x 70	82 x 70	80 x 70
Stroke h3, mm	115	115	115
Height of control handle h14, mm	1200	1200	1230
Fork height lowered h13, mm	85	85	85
Fork width e, mm	160	160	160
Fork length l, mm	1150	1150	1150
Outside dimension of forks b1, mm	450	850	685

<sup>1</sup>PUR... Polyurethane, VG... Solid rubber

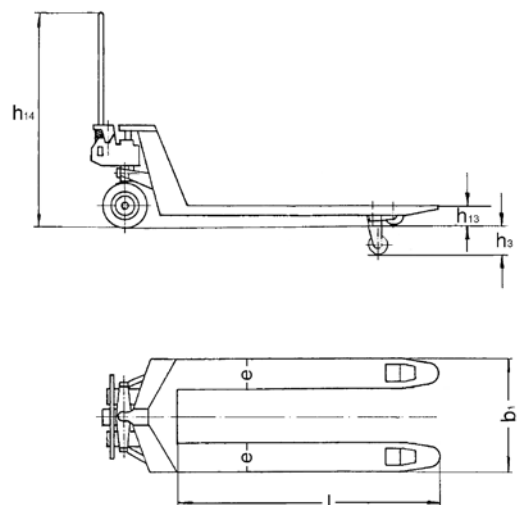

## HU 15-115 FTP PROLINE Hand pallet truck with low height forks

**Capacity 1500 kg**

For the professional transportation of particularly low pallets.

### Features

- Ergonomic safety control handle for one-hand operation of lifting, driving and lowering.
- Ergonomic rubber control handle for safe handling.
- Low maintenance high performance hydraulic pump with hard chromium plated piston and pressure relief valve.
- Frame and forks in robust steel construction, adjustable connecting rods, especially hardened axles and the high quality powder coating ensure a long life expectancy.
- Pallet entry height of only 51 mm for easy entry in particularly low pallets.
- Steering angle of 105 degree to each side for easy handling in confined spaces.



### Technical data HU 15-115 FTP

Model	HU 15-115 FTP
Art.-No.	34527124
Capacity, kg	1500
Weight, kg	84
Tyre type <sup>1</sup>	PUR/PA
Steering rollers, mm	180 x 50
Load rollers, mm	50 x 70
Stroke h3, mm	115
Height of control handle h14, mm	1200
Fork height lowered h13, mm	51
Fork width e, mm	160
Fork length l, mm	1150
Outside dimension of forks b1, mm	540

<sup>1</sup>PUR... Polyurethane, PA... Polyamide

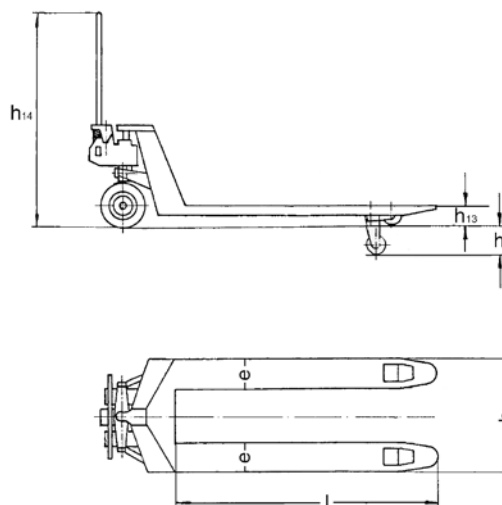

## Hand pallet truck PROLINE with short forks

**Capacity 2500 kg**

For the professional transportation of short palletised goods and box pallets under demanding conditions.

### Features

- Ergonomic safety control handle for one-hand operation of lifting, driving and lowering.
- Ergonomic rubber control handle for safe handling.
- Low maintenance high performance hydraulic pump with hard chromium plated piston and pressure relief valve.
- Frame and forks in robust steel construction, adjustable connecting rods, especially hardened axles and the high quality powder coating ensure a long life expectancy.
- Fork lengths from 600 up to 1000 mm for transportation of small loads.
- Steering angle of 105 degree to each side for easy handling in confined spaces.
- Available with tandem (TP) or single rollers (EP).



### Technical data hand pallet truck PROLINE with short forks

Model	HU 25-60 EP	HU 25-80 EP	HU 25-80 TP	HU 25-90 TP	HU 25-100 TP
Art.-No.	40011694	N21225221	N21225450	N21225451	N21225452
Capacity, kg	2500	2500	2500	2500	2500
Weight, kg	59	63	64	67	66
Tyre type <sup>1</sup>	VG/PA	VG/PUR	VG/PUR	VG/PUR	VG/PUR
Steering rollers, mm	200 x 50	200 x 50	200 x 50	200 x 50	200 x 50
Load rollers, mm	82 x 70	80 x 93	80 x 70	80 x 70	80 x 70
Stroke h3, mm	115	115	115	115	115
Height of control handle h14, mm	1200	1230	1230	1230	1230
Fork height lowered h13, mm	85	85	85	85	85
Fork width e, mm	160	160	160	160	160
Fork length l, mm	600	800	800	900	1000
Outside dimension of forks b1, mm	540	540	540	540	540

<sup>1</sup>PA... Polyamide, PUR... Polyurethane, VG... Solid rubber

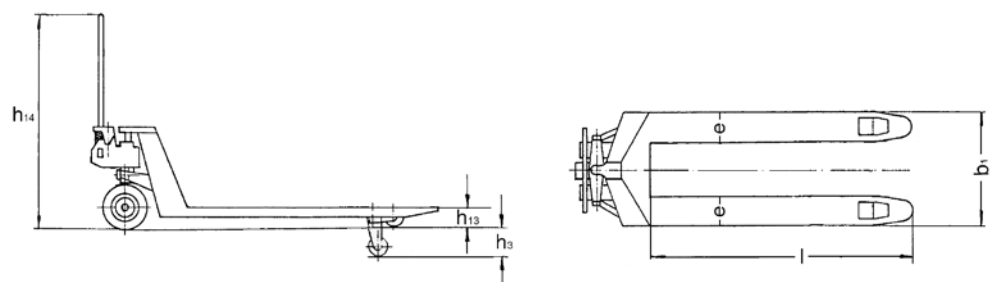

## Hand pallet truck PROLINE for heavy loads

Capacity 3000 kg

For the professional transportation of heavy loads.

### Features

- Ergonomic safety control handle for one-hand operation of lifting, driving and lowering.
- Ergonomic rubber control handle for safe handling.
- Low maintenance high performance hydraulic pump with hard chromium plated piston and pressure relief valve.
- Frame and forks in robust steel construction, adjustable connecting rods, especially hardened axles and the high quality powder coating ensure a long life expectancy.



### Technical data hand pallet truck PROLINE for heavy loads

Model	HU 30-115 TP
Art.-No.	N21230415
Capacity, kg	3000
Weight, kg	73
Tyre type <sup>1</sup>	PUR/PUR
Steering rollers, mm	200 x 50
Load rollers, mm	80 x 70
Stroke h <sub>3</sub> , mm	115
Height of control handle h <sub>14</sub> , mm	1230
Fork height lowered h <sub>13</sub> , mm	85
Fork width e, mm	160
Fork length l, mm	1150
Outside dimension of forks b <sub>1</sub> , mm	540

<sup>1</sup>PUR... Polyurethane

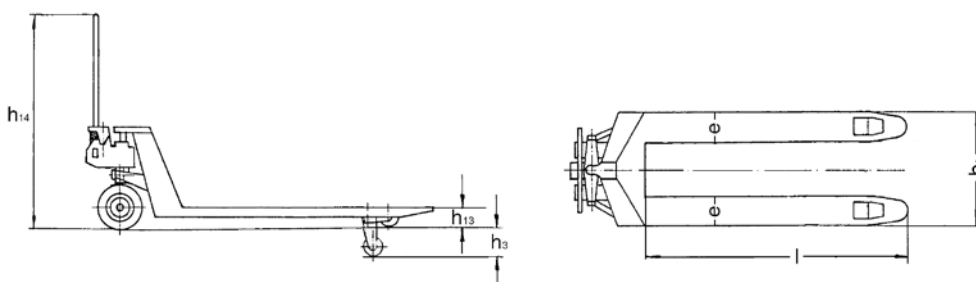

## Hand pallet truck PROLINE with extended forks

Capacity 2000 - 2500 kg

For the professional transportation of long palletised goods and box pallets under demanding conditions.

### Features

- Ergonomic safety control handle for one-hand operation of lifting, driving and lowering.
- Ergonomic rubber control handle for safe handling.
- Low maintenance high performance hydraulic pump with hard chromium plated piston and pressure relief valve.
- Frame and forks in robust steel construction, adjustable connecting rods, especially hardened axles and the high quality powder coating ensure a long life expectancy.
- Fork lengths from 1300 up to 3000mm for transportation of long and bulky loads.
- Steering angle of 105 degree to each side for easy handling in confined spaces.



Option: Parking brake

## INFO

Driving and parking brake available as option.

### Technical data hand pallet truck PROLINE with extended forks

Model	HU 25-130 TP	HU 20-150 TP	HU 20-180 TP	HU 20-200 TP	HU 20-250 TP
Art.-No.	N21225453	N21225454	N21225455	N21225456	34527202
Capacity, kg	2500	2000	2000	2000	2000
Weight, kg	81	82	92	97	275
Tyre type <sup>1</sup>	VG/PUR	VG/PUR	VG/PUR	VG/PUR	PUR/PUR
Steering rollers, mm	200 x 50	200 x 50	200 x 50	200 x 50	200 x 50
Load rollers, mm	80 x 70	80 x 70	80 x 70	80 x 70	82 x 70
Stroke h3, mm	115	115	115	115	115
Height of control handle h14, mm	1230	1230	1230	1230	1200
Fork height lowered h13, mm	85	85	85	85	85
Fork width e, mm	160	160	160	160	170
Fork length l, mm	1300	1500	1800	2000	2500
Outside dimension of forks b1, mm	540	540	540	540	550

<sup>1</sup>PUR...Polyurethane, VG...Solid rubber Other versions available on request

## Hand pallet truck PROLINE with extended forks and increased capacity

Capacity 3000 - 3500 kg

For the professional transportation of long palletised goods and box pallets under demanding conditions.

### Features

- Ergonomic safety control handle for one-hand operation of lifting, driving and lowering.
- Ergonomic rubber control handle for safe handling.
- Low maintenance high performance hydraulic pump with hard chromium plated piston and pressure relief valve.
- Frame and forks in robust steel construction, adjustable connecting rods, especially hardened axles and the high quality powder coating ensure a long life expectancy.
- Fork lengths from 1500 up to 2000 mm for transportation of long goods.
- Steering angle of 105 degree to each side for easy handling in confined spaces.



### INFO

With extended forks up to 2000 mm and increased capacity up to 3500 kg.

### Technical data hand pallet truck PROLINE with extended forks and increased capacity

Model	HU 30-150 TP	HU 35-180 TP	HU 35-200 TP
Art.-No.	34527204	34527205	34527206
Capacity, kg	3000	3500	3500
Weight, kg	121	139	148
Tyre type <sup>1</sup>	PUR/PUR	PUR/PUR	PUR/PUR
Steering rollers, mm	200 x 50	200 x 50	200 x 50
Load rollers, mm	82 x 70	82 x 70	82 x 70
Stroke h3, mm	115	115	115
Height of control handle h14, mm	1200	1200	1200
Fork height lowered h13, mm	85	85	85
Fork width e, mm	160	170	170
Fork length l, mm	1500	1800	2000
Outside dimension of forks b1, mm	540	550	550

<sup>1</sup>PUR... Polyurethane

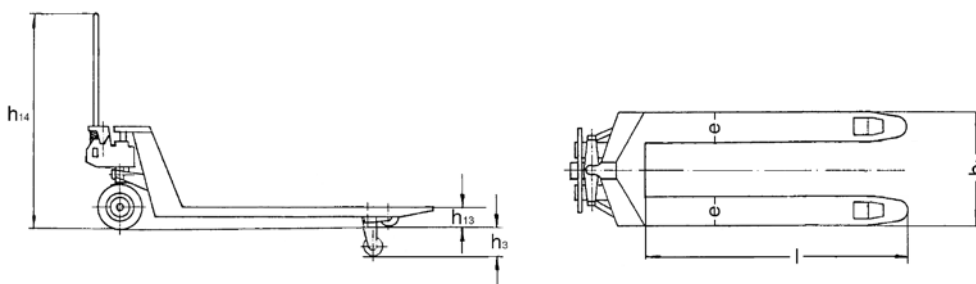

## HU 20-115 QLTP PROLINE Hand pallet truck with quick-lift

Capacity 2000 kg

For quick lifting and professional transportation of palletised goods and box pallets under demanding conditions.

### Features

- Ergonomic safety control handle for one-hand operation of lifting, driving and lowering.
- Ergonomic rubber control handle for safe handling.
- Low maintenance high performance hydraulic pump with hard chromium plated piston and pressure relief valve.
- Quick-lift function for loads up to 200 kg for quick lifting of the load.
- Frame and forks in robust steel construction, adjustable connecting rods, especially hardened axles and the high quality powder coating ensure a long life expectancy.
- Steering angle of 105 degree to each side for easy handling in confined spaces.

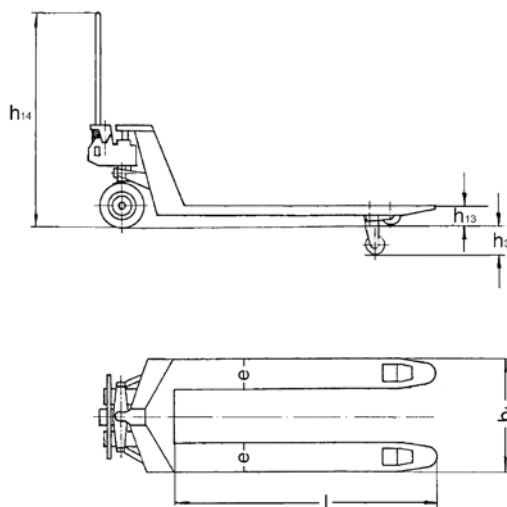

### Technical data HU 20-115 QLTP

Model	HU 20-115 QLTP
Art.-No.	N21225458
Capacity, kg	2000
Weight, kg	86
Tyre type <sup>1</sup>	VG/PUR
Steering rollers, mm	200 x 50
Load rollers, mm	82 x 70
Stroke h3, mm	115
Height of control handle h14, mm	1200
Fork height lowered h13, mm	85
Fork width e, mm	160
Fork length l, mm	1150
Outside dimension of forks b1, mm	540

<sup>1</sup>PUR... Polyurethane, VG... Solid rubber

## HU 25-115 FBTP PROLINE Hand pallet truck with driving and parking brake

Capacity 2500 kg

For the professional transportation of palletised goods and box pallets, on ramps, ascending slopes and on lorries.

### Features

- Ergonomic safety control handle for one-hand operation of lifting, driving and lowering.
- Ergonomic rubber control handle for safe handling.
- Driving and park brake comfortably operated from the control handle.
- Low maintenance high performance hydraulic pump with hard chromium plated piston and pressure relief valve.
- Frame and forks in robust steel construction, adjustable connecting rods, especially hardened axles and the high quality powder coating ensure a long life expectancy.
- Steering angle of 105 degree to each side for easy handling in confined spaces.



### Technical data 25-115 FBTP

Model	HU 25-115 FBTP
Art.-No.	34527135
Capacity, kg	2500
Weight, kg	86
Tyre type <sup>1</sup>	VG/PUR
Steering rollers, mm	180 x 50
Load rollers, mm	82 x 70
Stroke h3, mm	115
Height of control handle h14, mm	1200
Fork height lowered h13, mm	85
Fork width e, mm	160
Fork length l, mm	1150
Outside dimension of forks b1, mm	540

<sup>1</sup>PUR... Polyurethane, VG... Solid rubber

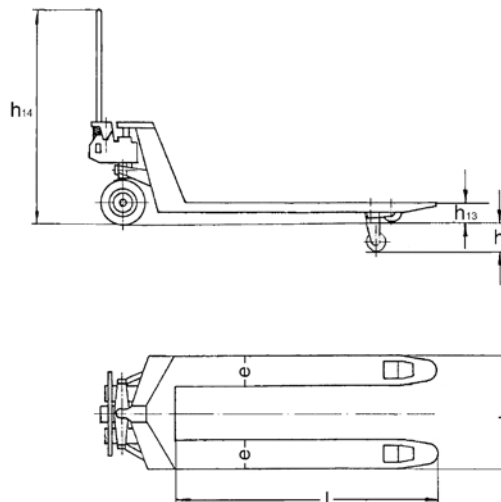





**HU W-20 SL SILVERLINE**  
**Hand pallet truck**  
**with weighing system**

**Capacity 2000 kg**

For transportation and weighing of palletised goods and box pallets. For simple weighing jobs and a rough calculation of total weights, e.g. when loading lorries.

**Features**

- The basic truck is the model Silverline HU 25-115.
- Ergonomic safety control handle for one-hand operation of lifting, driving and lowering.
- Ergonomic rubber control handle for safe handling.
- Measuring range from 0 up to 2000 kg in 5 kg steps.
- Easy to read LCD display.
- Accuracy:  
 0 - 1000 kg → ± 20 kg  
 1000 - 2000 kg → ± 40 kg

**Scope of delivery**

- 2 x 1.5 V AA batteries  
 (sufficient for approx. 3000 weighing operations)

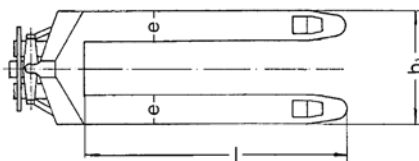
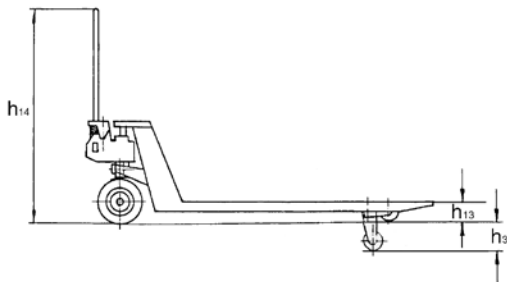

**Technical data HU W-20 SL**

Model	HU W 20 SL
Art.-No.	40048616
Capacity, kg	2000
Load center c, mm	600
Weight, kg	76
Tyre type <sup>1</sup>	VG/PUR
Steering rollers D, mm	200 x 50
Load rollers D1, mm	82 x 70
Number of wheels/load rollers	2/4
Stroke h2, mm	115
Lifting height h3, mm	200
Height of control handle h14, mm	1200
Fork height lowered h13, mm	85
Overall length L1, mm	1535
Fork height s, mm	45
Fork width e, mm	160
Fork length l, mm	1150
Outside dimension of forks b1, mm	540
Ground clearance m1, mm	40
Turning circle radius, mm	1330
Ambient temperature	-5 °C up to +40 °C

<sup>1</sup>VG... Solid rubber, PUR... Polyurethane

## HU W-20 S SILVERLINE

### Hand pallet truck

-with weighing system

## HU W-20 SPR SILVERLINE

-with weighing system and printer

Capacity 2000 kg

For transportation and weighing of palletised goods and box pallets

### Features

- Ergonomic safety control handle for one-hand operation of lifting, driving and lowering.
- Ergonomic rubber control handle for safe handling.
- Measuring range from 0 up to 2000 kg in 1 kg steps.
- Easy to read LCD display.
- Accuracy  $\pm 0.1\%$  of the end value.
- The readings start at 1.0 kg.
- The system is designed for simple weighing jobs, such as batching or filling processes.
- Low maintenance hydraulic pump with hard chromium plated piston and pressure relief valve.
- Frame and forks in robust steel construction, adjustable connecting rods, especially hardened axles and the high quality powder coating ensure a long life expectancy.
- Steering angle of 105 degree to each side for easy handling in confined spaces.

### Scope of delivery

- 4 x 1.5 V AA batteries  
(sufficient for approx. 3000 weighing operations)



HU W-20 SPR SILVERLINE  
with weighing system and printer

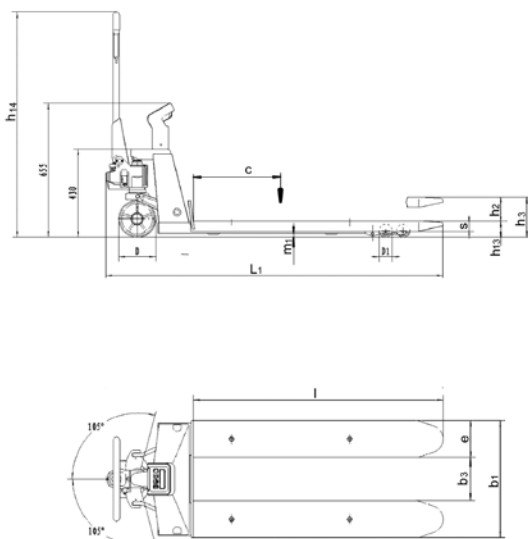

### Technical data HU W-20 S and HU W-20 SPR

Model	HU W 20 S	HU W 20 SPR
Art.-No.	40016431	N21220615
Capacity, kg	2000	2000
Load center c, mm	600	600
Weight, kg	129	131
Tyre type <sup>1</sup>	PUR/PUR	PUR/PUR
Steering rollers D, mm	180 x 50	180 x 50
Load rollers D1, mm	74 x 70	74 x 70
Number of wheels/load rollers	2/4	2/4
Stroke h2, mm	110	110
Lifting height h3, mm	195	195
Height of control handle h14, mm	1210	1210
Fork height lowered h13, mm	85	85
Overall length L1, mm	1580	1580
Fork height s, mm	50	50
Fork width e, mm	180	180
Fork length l, mm	1150	1150
Outside dimension of forks b1, mm	570	570
Inside dimension of forks b3, mm	210	210
Ground clearance m1, mm	35	35
Turning circle radius, mm	1330	1330
Ambient temperature	-10 °C up to +40 °C	-10 °C up to +40 °C

<sup>1</sup>PUR... Polyurethane



## HU HS 10 B Scissor pallet truck with manual-hydraulic lift

Capacity 1000 kg,  
fork height max. 800 mm

A combination of hand pallet truck and elevating platform for the transport and raising of palletised loads to various departments.

### Features

- Safety control handle with the functions:  
Quick-lift - lifting - lowering.
- Lowering speed can be finely metered for sensitive lowering of the load.
- One-stage hydraulic for increased robustness.
- Overload protection by pressure relief valve.
- Safety supports guarantee sure standing when the forks are raised.
- Low noise and smooth running with standard tyres:  
steer rollers and load rollers – polyurethane.

### Technical data HU HS 10 B

Model	HU HS 10 B
Art.-No.	N26600020
Capacity Q, kg	1000
Load center c, mm	600
Weight, kg	122
Tyre type <sup>1</sup>	PUR/PUR
Steering rollers, mm	180 x 50
Load rollers, mm	75 x 50
Number of wheels/load rollers	2/2
Stroke h <sub>3</sub> , mm	715
Height of control handle max. h <sub>14</sub> , mm	1254
Fork height lowered h <sub>13</sub> , mm	85
Overall length l <sub>1</sub> , mm	1725
Overall width b <sub>1</sub> /b <sub>2</sub> , mm	575
Fork height s, mm	45
Fork width e, mm	160
Fork length l, mm	1170
Outside dimension of forks b <sub>5</sub> , mm	540
Ground clearance, wheelbase centre m <sub>2</sub> , mm	18
Aisle width pallet A <sub>st</sub> , mm	1986
Turning circle radius W <sub>a</sub> , mm	1564

<sup>1</sup>PUR... Polyurethane

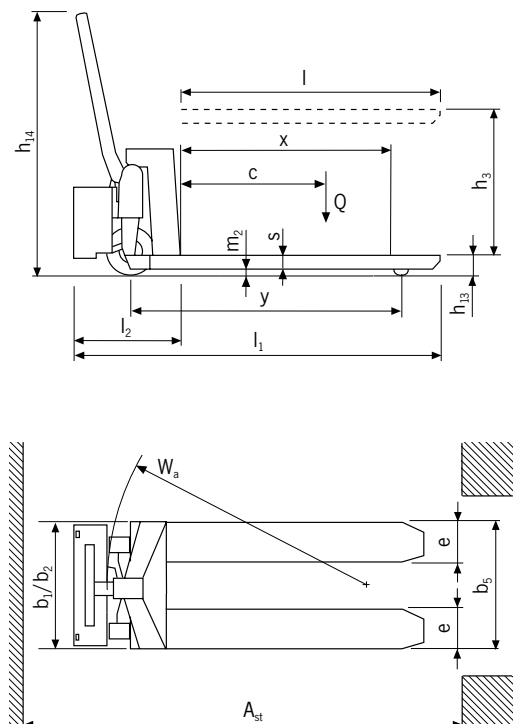

## HU ES 10 B Scissor pallet truck with electric-hydraulic lift

Capacity 1000 kg,  
fork height max. 800 mm

The HU ES 10 B increases the usefulness of the HU HS 10 B by saving operating time for demanding applications with frequent lifting and lowering operations.

### Features

- Ergonomic control button for the hydraulic unit fitted in the handle.
- In case of a battery failure the manual use of lifting and lowering is still guaranteed.
- Quick electric-hydraulic lifting of the load, pressure relief valve protects against overloading.
- Low noise and smooth running due to polyurethane steering and load rollers as standard.
- Additional tilting protection for the load rollers.

### Scope of delivery

- Battery and integrated battery charger

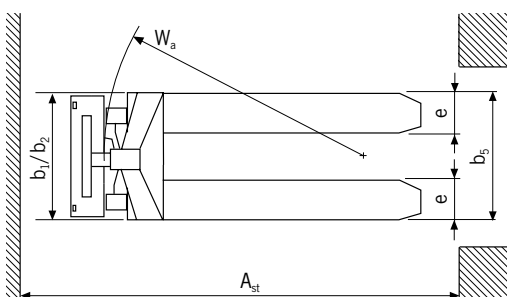
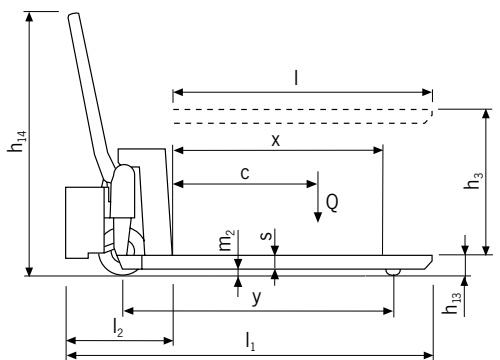

### Technical data HU ES 10 B

Model	HU ES 10 B
Art.-No.	N26900020
Capacity Q, kg	1000
Load center c, mm	600
Weight, kg	152
Tyre type <sup>1</sup>	PUR/PUR
Steering rollers, mm	180 x 50
Load rollers, mm	75 x 50
Number of wheels/load rollers	2/2
Stroke h3, mm	715
Height of control handle max. h14, mm	1254
Fork height lowered h13, mm	85
Overall length l1, mm	1715
Overall width b1/b2, mm	575
Fork height s, mm	45
Fork width e, mm	160
Fork length l, mm	1170
Outside dimension of forks b5, mm	540
Ground clearance, wheelbase centre m2, mm	18
Aisle width pallet Ast, mm	1986
Turning circle radius Wa, mm	1564
Battery charger, V/A	220/6
Battery voltage, capacity K5, V/Ah	12/52

<sup>1</sup>PUR... Polyurethane



## HU 12-115 TP **Li-ION** Hand pallet truck with electric drive

### Capacity 1200 kg

For the transport of palletised goods in the in-house area, on flat floors and short to medium distances.

Reduced noise emission, compact size and small turning radius make it the ideal helper for supermarkets, retailers and workshops.

Supplied as standard with a replaceable battery, the discharged battery can be exchanged with a fully charged battery within seconds, minimising the amount of disruption to the work cycle (second battery as option).

### Features

- 2 traction wheels for better traction and longer lifetime
- Maintenance-free rechargeable Lithium battery for quick charging
- Charging time of only 2.5 hours – 80% within 1 hour
- Infinitely variable driving speed
- Switchable between electric and manual drive
- highest speed of its class
- key switch for locking the truck
- non marking traction wheels
- turning radius of 1382 mm only - identical to the normal truck
- 5% gradient with load
- External charger for quick charging with a 230V plug socket

### Scope of delivery

- 1 Li-ION Akku 36Volt, 10.4 A
- External charger

## **Li-ION** battery

This battery offers much longer operational periods and overall lifetime with shorter charges.

- The Li-ION battery has a lifespan of up to 3000 charging cycles.
- Charging time of only 2.5 hours.
- Intermediate charge is possible without affecting the lifetime of the battery.
- No loss of power when the battery charge state drops.



User panel



Key switch



Technical data HU 12-115 TP Li-ION

Model	HU 12-115 TP <i>Li-ION</i>
Art.-No.	N23312431
Capacity, kg	1200
Tyre type <sup>1</sup>	VG/PUR
Steering rollers l x d, mm	200 x 40
Load rollers l x d, mm	82 x 60
Number of wheels/load rollers (x=driven)	2x/4
Wheelbase Y, mm	1192
Stroke h3, mm	115
Load center c, mm	600
Fork height max., mm	200
Fork height lowered, mm	85
Height of control handle max. h14, mm	1185
Overall length l1, mm	1600
Length incl. apron l2, mm	450
Overall width b1, mm	525
Fork dimensions s/e/l, mm	55 x 150 x 1150
Outside dimension of forks b5, mm	525
Aisle width pallet Ast, mm	2063
Turning circle radius Wa, mm	1382
Actuation	electric
Operation	pedestrian
Travel speed with/without load, km/h	4.2/5.3
Lowering speed with/without load, m/s	0.01/0.02
Gradient with/without load, %	5/10
Drive motor rating, kW	2 x 0.25
Service brake	electric
Battery	Li-ION
Battery voltage 20 h, in V/Ah	36/10.4
Weight with battery, kg	88

<sup>1</sup>VG... Solid rubber, PUR... Polyurethane



Fast battery change – with a single touch

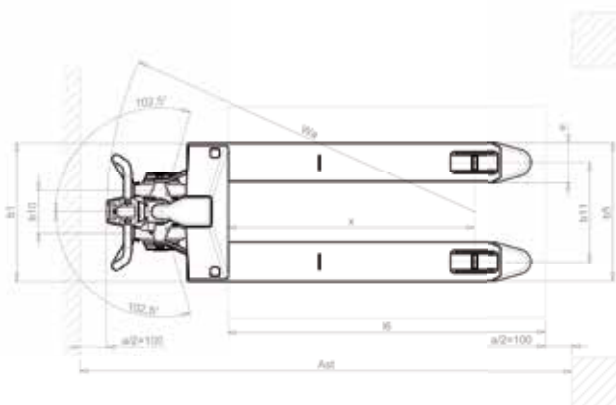
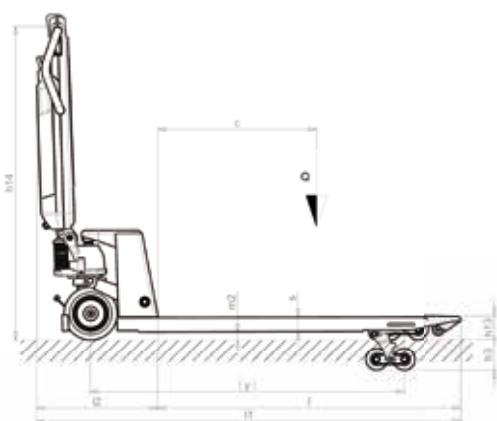



Optional: replaceable battery with 20Ah, 30Ah or 36Ah



Fast battery change – with a single touch

## EGU 15 E **Li-ION** Electric pallet trucks

### Capacity 1500 kg

Ideal for internal transport of palletised goods on even ground, covering short to medium distances.

The EGU 15 E is the new generation of electric pallet trucks. With its compact dimensions and new Lithium battery, it is an ideal alternative to the standard pallet truck and, with only 123 kg service weight the perfect driving device on a truck.

Supplied as standard with a replaceable battery the discharged battery can be exchanged with a fully charged battery within seconds, minimising the amount of disruption to the work cycle. Charging time for the battery is only 2.5 hours.

### Features

- Maintenance-free rechargeable Lithium battery.
- Integrated battery management system controls all important parameters and performance of the lithium battery.
- Charging time of only 2.5 hours, intermediate charge is possible.
- Integrated PIN code panel with LCD display.
- Curtis-Controller and CAN-Bus technology.
- Infinitely variable driving speed.
- External battery charger for charging with a 230V plug socket.
- Battery charge indicator and operating hour counter.
- Entry rollers ensure smooth entry into bottom-boarded pallets.

### Scope of delivery

- Maintenance free rechargeable Lithium battery 24 Volt/20 Ah (30 or 36 Ah as option)
- External charger

## **Li-ION** battery

---

This battery offers much longer operational periods and overall lifetime with shorter charges.

- The Li-ION battery has a lifespan of up to 3000 charging cycles.
- Charging time of only 2.5 hours.
- Intermediate charge is possible without affecting the lifetime of the battery.
- No loss of power when the battery charge state drops.

Technical data EGU 15 E Li-ION

Model	EGU 15 E <i>Li-ION</i>
Art.-No.	N23315461
Capacity, kg	1500
Tyre type <sup>1</sup>	PUR/PUR
Steering rollers l x d, mm	210 x 70
Load rollers l x d, mm	80 x 93
Number of wheels/load rollers (x=driven)	2 + 1x/4
Stroke h3, mm	115
Load center c, mm	600
Fork height max., mm	195
Fork height lowered h13, mm	85
Height of control handle h14, mm	1160
Overall length l1, mm	1530
Overall width b1, mm	540
Fork dimensions s/e/l, mm	47 x 160 x 1150
Outside dimension of forks b5, mm	540
Aisle width pallet Ast, mm	2000
Turning circle radius Wa, mm	1330
Actuation	electric
Operation	pedestrian
Travel speed with/without load, km/h	4.6/4.8
Lifting speed with/without load, m/s	0.020/0.025
Lowering speed with/without load, m/s	0.05/0.04
Gradient with/without load, %	5/10
Drive motor rating, kW	0.65
Hoist motor rating, kW	0.5
Service brake	electric
Battery	Li-ION
Battery voltage, V/Ah	24/20
Weight with battery in kg	123

<sup>1</sup>PUR... Polyurethane

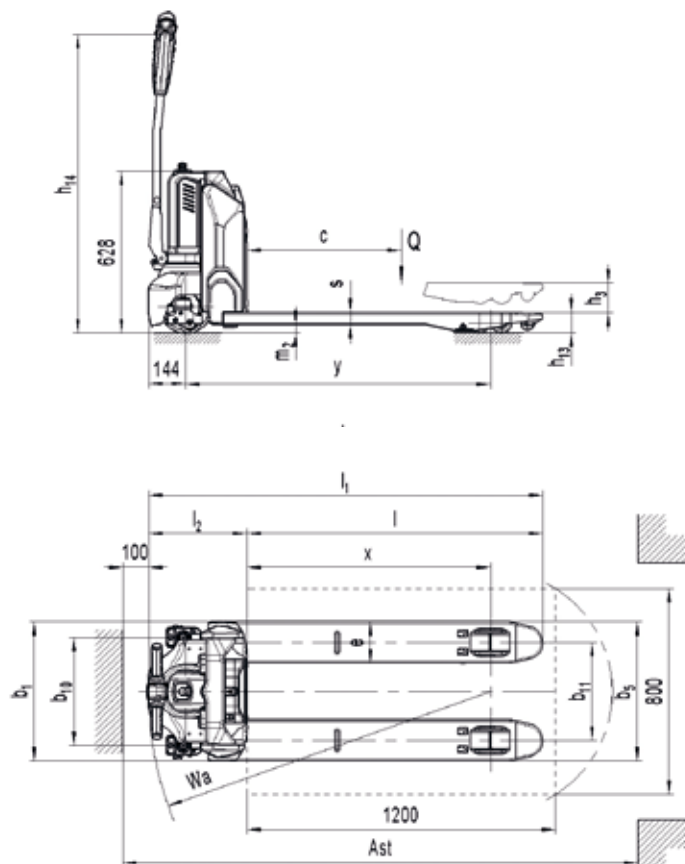





## EGU PS 14 Electric pallet trucks

### Capacity 1400 kg

Electrical drive, electrical lifting.

Ideal for the transportation of palletised goods within a warehouse environment.

Due to the extremely small turning circle it is also ideal for working on ramps or taking along on a lorry. The powerful motor allows fast operation.

The truck is available in three versions:

EGU PS 14 Basic

EGU PS 14 Plus and

EGU PS 14 **Li-ION**

### Features

- Reduced dimensions: L2 only 410 mm.
- Creep speed button for pin-point work in confined spaces.
- Reliable impulse control for stepless regulation of driving speed.
- Integrated battery charger for charging on a 230V plug socket.
- Digital display for battery status

---

### EGU PS 14 Basic

The unit is supplied with a DC traction motor and a tubular steel drawbar with integrated controls. The Basic version is the entry level model.

---

### EGU PS 14 Plus

The Plus Version with the powerful Gel battery gives a plus in capacity and a longer battery life. The Plus also includes a maintenance-friendly AC traction motor with reduced power consumption and higher driving speed. The ergonomically designed multifunctional drawbar contains all operating and control functions, such as hour meter and charging indicator.

---

### EGU PS 14 **Li-ION**

These versions offers much longer operational periods and overall lifetime of the battery with shorter charges.

- The Li-ION battery has a lifespan of up to 3000 charging cycles.
- Charging time of only 2.5 hours.
- Intermediate charge is possible without affecting the lifetime of the battery.
- No loss of power when the battery charge state drops.

## Technical data EGU PS 14

Model	EGU PS 14 Basic	EGU PS 14 Plus	EGU PS 14 <i>Li-ION</i>
Art.-No.	192062096	192062097	192062098
Capacity, kg	1400	1400	1400
Tyre type <sup>1</sup>	VG/PUR	VG/PUR	VG/PUR
Steering rollers l x d, mm	250 x 76 + 100 x 40	250 x 76 + 100 x 40	250 x 76 + 100 x 40
Load rollers l x d, mm	82 x 80	82 x 80	82 x 80
Number of wheels/load rollers (x=driven)	2 + 1x/2	2 + 1x/2	2 + 1x/2
Wheelbase Y, mm	1196	1196	1196
Stroke h2, mm	115	115	115
Load center c, mm	600	600	600
Fork height max. h3, mm	200	200	200
Fork height lowered, mm	85	85	85
Height of control handle max., mm	1230	1230	1230
Overall length L, mm	1560	1560	1560
Length incl. apron L2, mm	410	410	410
Overall width B, mm	720	720	720
Fork dimensions s1/n/l, mm	50 x 150 x 1150	50 x 150 x 1150	50 x 150 x 1150
Outside dimension of forks m, mm	525	525	525
Aisle width pallet Ast, mm	1810	1810	1810
Turning circle radius Wa, mm	1345	1345	1345
Actuation	electric	electric	electric
Operation	pedestrian	pedestrian	pedestrian
Travel speed with/without load, km/h	4.4/4.8	6.0/6.0	6.0/6.0
Lifting speed with/without load, m/s	0.03/0.04	0.03/0.04	0.03/0.04
Lowering speed with/without load, m/s	0.05/0.04	0.05/0.04	0.05/0.04
Gradient with/without load, %	5/10	5/10	5/10
Drive motor rating, kW	0.7	0.7	0.7
Hoist motor rating, kW	1.0	1.0	1.0
Service brake	electric	electric	electric
Battery	starter	Gel	Li-ION
Battery voltage 20 h, in V/Ah	24/70	24/65	24/50
Weight with battery in kg	227	256	212

<sup>1</sup>VG... Solid rubber, PUR... Polyurethane

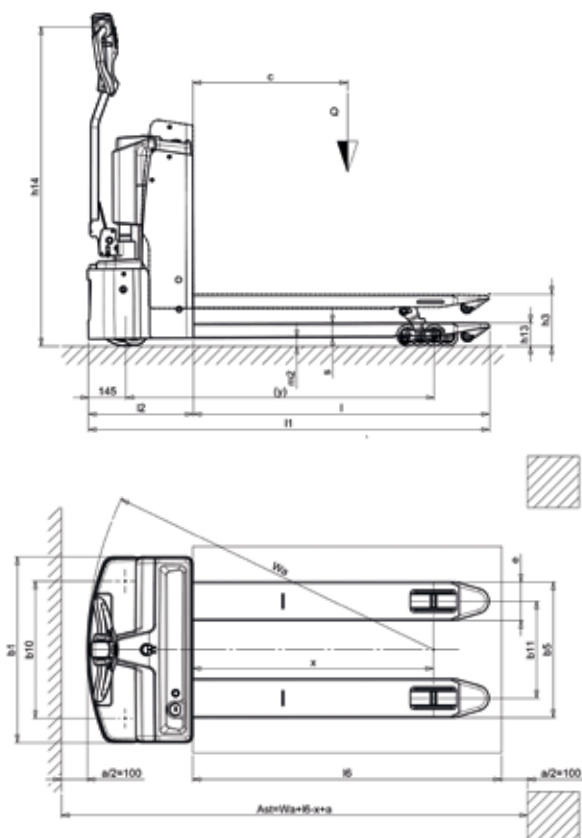

*Our top seller  
with over half a million  
units sold!*

Ergonomically designed control handle with rubber coating for better grip.

Infinitely variable lowering speed.

Reinforced construction for greater stability.

Fork entry rollers make easy entry into the wide side of Euro pallets.

Galvanized, maintenance-friendly, and extremely durable hydraulic unit with integral reservoir. The enclosed hydraulic system protects against damage.

5 different tyre combinations to suit all your needs.

## HV 0516 Manual drive stacker with manual-hydraulic lift

Capacity 500 kg

Ideal for the occasional, internal application of stacking and transporting of palletised goods, loading and unloading of shelves and lorries.

### Features

- Ergonomic safety control handle for one-hand operation of lifting, driving and lowering.
- Handlebars for easy operation.
- Lowering speed can be finely metered for sensitive lowering of the load.
- Single-acting hand pump with increased lift per handle stroke.
- Robust mast construction with hard chromium plated piston.
- Steering roller with brake for safe parking of the hand stacker.

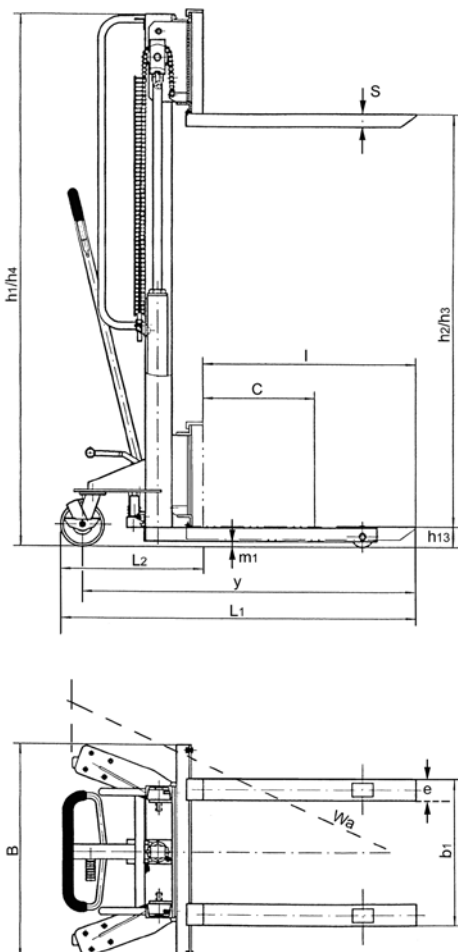

### Technical data HV 0516

Model	HV 0516
Art.-No.	40005551
Capacity, kg	500
Load center c, mm	600
Wheelbase y, mm	1630
Weight, kg	160
Tyre type <sup>1</sup>	PA/PUR
Steering rollers, mm	145 x 40
Load rollers, mm	80 x 35
Number of wheels/load rollers	2/2
Height, mast retracted h1, mm	2000
Freelift h2, mm	1520
Stroke h3, mm	1520
Height, mast extended h4, mm	2000
Lifting height max. h3 + h13, mm	1600
Fork height lowered h13, mm	90
Overall length L1, mm	1750
Length incl. apron L2, mm	480
Overall width B, mm	830
Fork height s, mm	50
Fork width e, mm	120
Fork length l, mm	1150
Outside dimension of forks adjustable up to b1, mm	270/810
Ground clearance m1, mm	25
Turning circle radius Wa, mm	1500
Lift per one crank rotation with/without load, mm	20/45

<sup>1</sup>PA... Polyamide, PUR... Polyurethane



### HV 1008 and HV 1016 Manual drive stacker

Capacity 1000 kg

Ideal for the occasional, internal application of stacking and transporting of palletised goods.

#### Features

- Ergonomic safety control handle for one-hand operation of lifting, driving and lowering.
- Easy handling due to forced steering rollers.
- Lowering speed can be finely metered for sensitive lowering of the load.
- Single-acting hand pump with increased lift per handle stroke.
- Quick-lift for loads up to 100 kg.
- Robust mast construction with hard chromium plated piston.
- Steering roller with brake for safe parking of the hand stacker.



## Technical data HV 1008 and HV 1016

Model	HV 1008	HV 1016
Art.-No.	34518032	34518030
Capacity, kg	1000	1000
Load center c, mm	600	600
Wheelbase y, mm	1075	1075
Weight, kg	179	205
Tyre type <sup>1</sup>	PUR/PUR	PUR/PUR
Steering rollers, mm	180 x 50	180 x 50
Load rollers, mm	80 x 55	80 x 55
Number of wheels/load rollers	2/2	2/2
Height, mast retracted h1, mm	1300	1965
Freelift h2, mm	810	1510
Stroke h3, mm	810	1510
Height, mast extended h4, mm	1300	1965
Lifting height max. h3 + h13, mm	900	1600
Fork height lowered h13, mm	90	90
Overall length L1, mm	1675	1675
Length incl. apron L2, mm	552	552
Overall width B, mm	765	765
Fork height s, mm	60	60
Fork width e, mm	60	60
Fork length l, mm	1122	1122
Outside dimension of forks b1, mm	570	570
Ground clearance m1, mm	25	25
Aisle width pallet Ast, mm	1875	1875
Turning circle radius Wa, mm	1445	1445
Lift per one crank rotation with/without load, mm	17/50	17/50

<sup>1</sup>PUR... Polyurethane

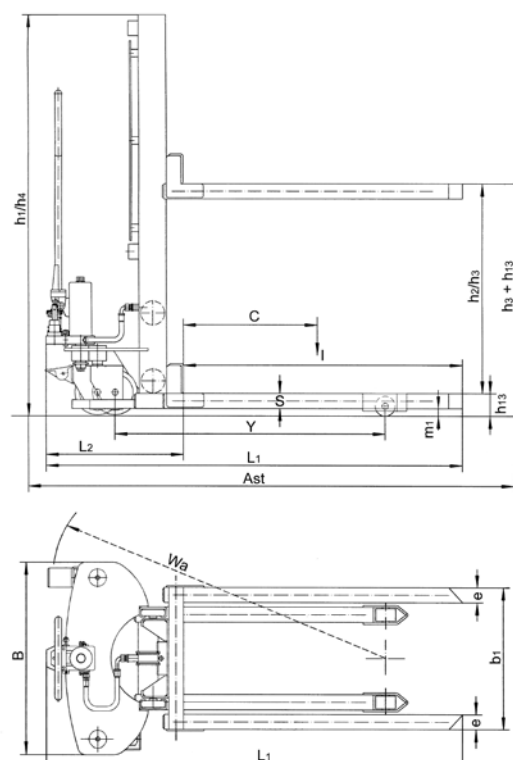

### EHH PSE Manual drive stacker with electric-hydraulic lift

Capacity 1000 kg,  
fork height max. 3000 mm

Suitable for occasional applications of stacking and transporting palletised loads, also for use in confined areas and for short distances.

#### Features

- Good maneuverability and easy handling due to positive steering of the unit.
- Compact electric-hydraulic lifting device and overload protection.
- Finely metered lowering of load through pressure relief valve and adjustable lowering valve.
- Retention by parking brake.
- Robust frame with two load and two steer rollers.
- The maintenance free battery can be charged at any 230V plug socket.

#### Scope of delivery

- Battery and battery charger included.





## Technical data EHH PSE

Model	EHH PSE 1016	EHH PSE 1025	EHH PSE 1030
Art.-No.	40050660	40050661	40050662
Capacity (up to 2.5 m lift), kg	1000	1000	1000
Load center c, mm	600	600	600
Wheelbase y, mm	1160	1160	1160
Weight (with battery), kg	395	455	475
Tyre type <sup>1</sup>	PA/PUR	PA/PUR	PA/PUR
Steering rollers, mm	180 x 50	180 x 50	180 x 50
Load rollers, mm	74 x 70	74 x 70	74 x 70
Number of wheels/load rollers	2/4	2/4	2/4
Height, mast retracted h1, mm	1980	1830	2080
Freelift h2, mm	1415	-	-
Stroke h3, mm	1515	2415	2915
Height, mast extended h4, mm	2030	3020	3515
Lifting height max. h3 + h13, mm	1600	2500	3000
Fork height lowered h13, mm	85	85	85
Overall length L1, mm	1720	1720	1720
Length incl. apron L2, mm	555	555	555
Overall width b1/b2, mm	765	765	765
Fork height s, mm	60	60	60
Fork width e, mm	180	180	180
Fork length l, mm	1100	1100	1100
Outside dimension of forks b5, mm	570	570	570
Ground clearance m2, mm	25	25	25
Aisle width pallet Ast, mm	2145	2145	2145
Turning circle radius Wa, mm	1280	1280	1280
Lifting speed with/without load, m/s	0.08/0.13	0.08/0.13	0.08/0.13
Lowering speed with/without load, m/s	0.42/0.19	0.42/0.19	0.42/0.19
Hoist motor rating, kW	1.5	1.5	1.5
Battery according to DIN 43531	semi traction battery	semi traction battery	semi traction battery
Battery charger, V/A	12/20A	12/20A	12/20A
Battery voltage, capacity, V/Ah	12/130	12/130	12/130

<sup>1</sup>PA... Polyamide, PUR... Polyurethane

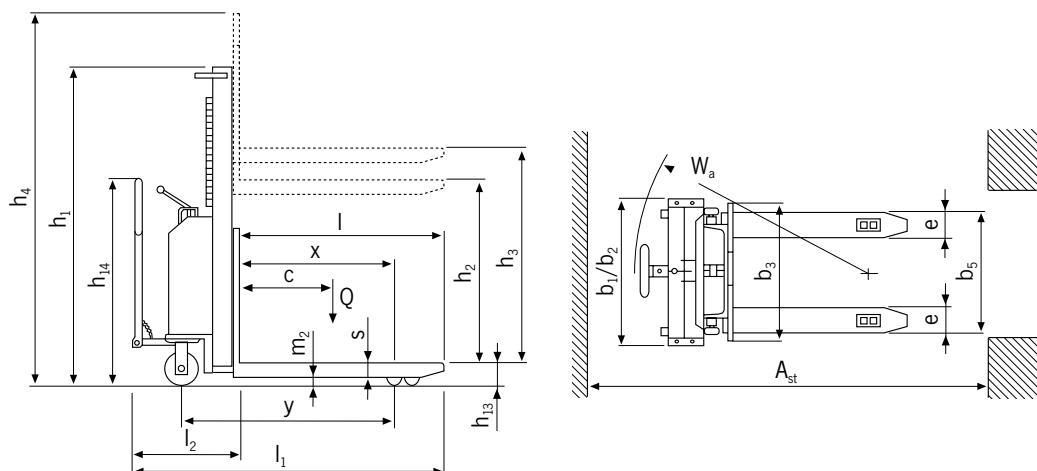



### EHH PS Manual drive stacker with electric-hydraulic lift

Capacity 1000 - 1200 kg,  
fork height max. 3500 mm

Suitable for occasional to medium applications of stacking and transporting palletised loads, also in confined areas.

#### Features

- Easy to operate via tie-rod guides to both steer wheels.
- Compact electric-hydraulic lifting device and overload protection.
- Finely metered lowering of load through pressure relief valve and adjustable lowering valve.
- Mast welded from precision profiles, fork carriage with maintenance free guide rollers.
- Retention by parking brake.
- Robust frame with two load and two steer rollers.

#### Scope of delivery

- Battery and battery charger included.



Technical data EHH PS

Model	EHH PS 1009	EHH PS 1016	EHH PS 1225	EHH PS 1229	EHH PS 1235
Art.-No.	40046051	40044422	40044424	40044425	40044426
Capacity (up to 2.5 m lift), kg	1000	1000	1200	1200	1200
Load center c, mm	600	600	600	600	600
Wheelbase y, mm	965	965	1155	1155	1155
Weight (with battery), kg	296	311	433	449	496
Tyre type <sup>1</sup>	VG/PA	VG/PA	PUR/PA	PUR/PA	PUR/PA
Steering rollers, mm	200 x 50	200 x 50	200 x 50	200 x 50	200 x 50
Load rollers, mm	82 x 70	82 x 70	82 x 70	82 x 70	82 x 70
Number of wheels/load rollers	2/2	2/2	2/2	2/2	2/2
Height, mast retracted h1, mm	1300	1970	1780	1980	2250
Freelift h2, mm	810	1510	-	-	80
Stroke h3, mm	810	1510	2410	2810	3410
Height, mast extended h4, mm	1300	1970	2985	3385	3915
Lifting height max. h3 + h13, mm	900	1600	2500	2900	3500
Fork height lowered h13, mm	90	90	90	90	90
Overall length L1, mm	1750	1750	1850	1850	1850
Length incl. apron L2, mm	600	600	700	700	700
Overall width b1/b2, mm	750	750	850	850	850
Fork height s, mm	70	70	70	70	70
Fork width e, mm	150	150	150	150	150
Fork length l, mm	1150	1150	1150	1150	1150
Outside dimension of forks b5, mm	560	560	560	560	560
Ground clearance m2, mm	20	20	20	20	20
Aisle width pallet Ast, mm	2210	2210	2375	2375	2375
Turning circle radius Wa, mm	1440	1440	1760	1760	1760
Lifting speed with/without load, m/s	0.09/0.12	0.09/0.12	0.08/0.12	0.08/0.12	0.08/0.12
Lowering speed with/without load, m/s	0.4/0.1	0.4/0.1	0.4/0.1	0.4/0.1	0.4/0.1
Hoist motor rating, kW	1.6	1.6	2.2	2.2	2.2
Battery according to DIN 43531	starter	starter	starter	starter	starter
Battery charger, V/A	12/10	12/10	12/10	12/10	12/10
Battery voltage, capacity, V/Ah	12/74	12/74	24/74	24/74	24/74

<sup>1</sup>PA... Polyamide, PUR... Polyurethane, VG... Solid rubber

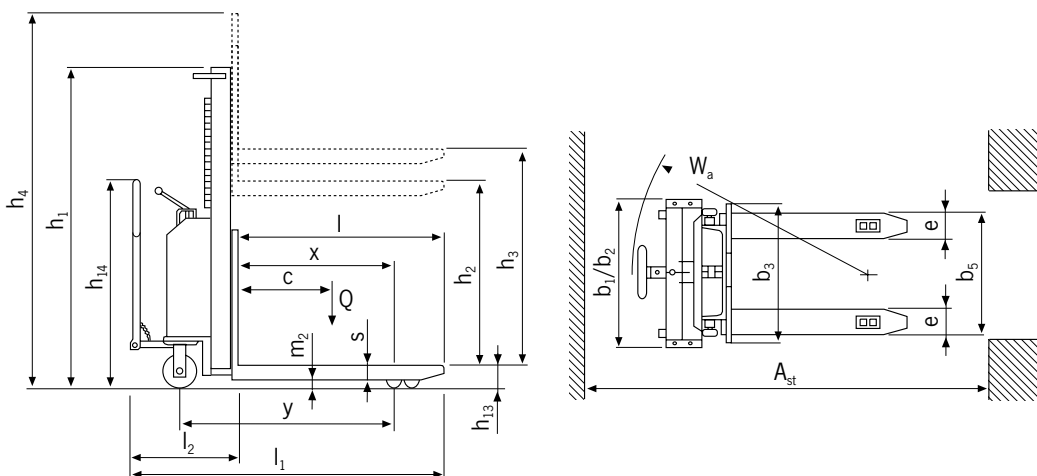

## EGV PSL 1016 II Electric pedestrian stacker

Capacity 1000 kg,  
fork height max. 1600 mm

The EGV PSL 1016 II is the ideal solution for indoor transportation and of palletised goods within a warehouse environment for short haul and medium work load applications.

### Features

- The slim single mast and the laterally, ergonomic tiller ensure a free view onto the goods as in front of the stacker.
- The fork thickness of 60 mm enables an easier entrance inside pallets, while working in elevation.
- Easy maintenance – the convenient access opening at the bottom of the forklift allows an immediate disassembly of motor wheel without lifting the machine.
- The reduced overall width of 794 mm improves the handling of goods in narrow spaces and corridors.
- Ultra-slow drive function enables exact driving in very tight spaces.
- Gel battery as standard.

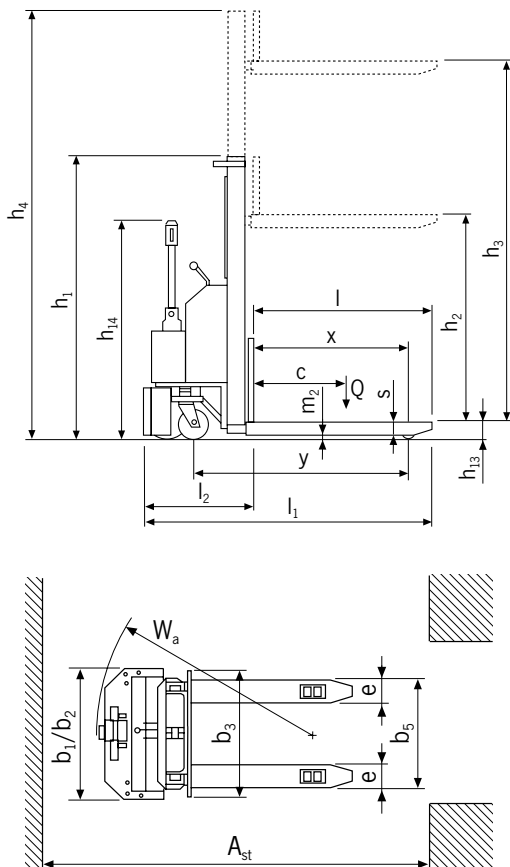

### Technical data EGV PSL 1016 II

Model	EGV PSL 1016 II
Art.-No.	192021784
Capacity (up to 2.5m lift), kg	1000
Steering rollers, mm	186 x 50 + 125 x 45
Load rollers, mm	82 x 70
Height, mast retracted h1, mm	1970
Freelift h2, mm	1510
Stroke, mm	1510
Height, mast extended h4, mm	1970
Fork height max. h3, mm	1600
Fork height lowered h13, mm	90
Overall length L1, mm	1675
Overall width b1/b2, mm	794
Fork height s, mm	60
Fork width e, mm	150
Fork length l, mm	1153
Outside dimension of forks b5, mm	560
Travel speed with/without load, km/h	3.7/4.3
Lifting speed with/without load, m/s	0.11/0.18
Lowering speed with/without load, m/s	0.18/0.18
Drive motor rating, kW	0.35
Hoist motor rating, kW	2.2
Battery	Gel
Battery charger, V/A	24/12
Battery voltage, V/Ah	24/50

## EGV PSL II

### Electric pedestrian stacker

Capacity 1200 kg,  
fork height max. 3500 mm

The revised EGV PSL II is the ideal solution for indoor transportation and of palletized goods within a warehouse environment for short haul and medium work load applications.

#### Features

- The wide mast and the laterally, ergonomic tiller ensure a free view onto the goods as in front of the stacker.
- All functions are comfortably controlled from the tiller head.
- The reduced overall width of 800 mm improves the handling of goods in narrow spaces and corridors.
- Ultra-slow drive function enables exact driving in very tight spaces.
- Easy maintenance – the convenient access opening at the bottom of the forklift allows an immediate disassembly of motor wheel without lifting the machine.
- Improved drive- and lifting speed.
- The spiral charging cable which can be stored in the chassis enables easy charging at every socket.

#### Options

##### Plus version

- Maintenance-free Gel batteries with increased working hours and a doubled lifetime expectancy.
- Finely metered lifting and lowering due to a soft valve control.
- Faster lowering speed

##### Freelift version

- The EGV PSL 1229 II plus Freelift has a fullfreelift. It can lift the forks up to 1500 mm without increasing the base mast height.

#### Scope of delivery

- Battery and battery charger included.



## Technical data EGV PSL II

Model	EGV PSL 1225 II	EGV PSL 1229 II	EGV PSL 1235 II
Art.-No.	192033602	192033615	192033616
Actuation	electric	electric	electric
Operation	pedestrian	pedestrian	pedestrian
Capacity (up to 2.5 m lift), kg	1200	1200	1200
Load center c, mm	600	600	600
Wheelbase y, mm	1234	1234	1234
Weight (with battery), kg	568	583	616
Tyre type <sup>1</sup>	PUR/VG + PUR	PUR/VG + PUR	PUR/VG + PUR
Steering rollers, mm	250 x 76 + 100 x 38	250 x 76 + 100 x 38	250 x 76 + 100 x 39
Load rollers, mm	82 x 70	82 x 70	82 x 70
Number of wheels/load rollers (x=driven)	1x + 1/2	1x + 1/2	1x + 1/2
Height, mast retracted h <sub>1</sub> , mm	1787	1987	2250
Freelift h <sub>2</sub> , mm	-	-	80
Stroke, mm	2410	2810	3410
Height, mast extended h <sub>4</sub> , mm	2992	3392	3916
Fork height max. h <sub>3</sub> , mm	2500	2900	3500
Height of control handle min./max. h <sub>14</sub> , mm	915/1310	915/1310	915/1310
Fork height lowered h <sub>13</sub> , mm	90	90	90
Overall length L <sub>1</sub> , mm	1760	1760	1760
Length incl. apron L <sub>2</sub> , mm	609	609	609
Overall width b <sub>1</sub> /b <sub>2</sub> , mm	800	800	800
Fork height s, mm	70	70	70
Fork width e, mm	150	150	150
Fork length l, mm	1150	1150	1150
Outside dimension of forks b <sub>5</sub> , mm	560	560	560
Ground clearance m <sub>2</sub> , mm	20	20	20
Aisle width pallet A <sub>st</sub> , mm	2210	2210	2210
Turning circle radius W <sub>a</sub> , mm	1430	1430	1430
Travel speed with/without load, km/h	4.7/5.2	4.7/5.2	4.7/5.2
Lifting speed with/without load, m/s	0.11/0.19	0.11/0.19	0.11/0.19
Lowering speed with/without load, m/s	0.12/0.15	0.12/0.15	0.12/0.15
Gradient with/without load, %	5/10	5/10	5/10
Service brake	electric	electric	electric
Drive motor rating, kW	0.7	0.7	0.7
Hoist motor rating, kW	2.2	2.2	2.2
Battery	starter	starter	starter
Battery charger, V/A	24/13	24/13	24/13
Battery voltage, V/Ah	24/85	24/85	24/85

<sup>1</sup>PUR... Polyurethane, VG... Solid rubber

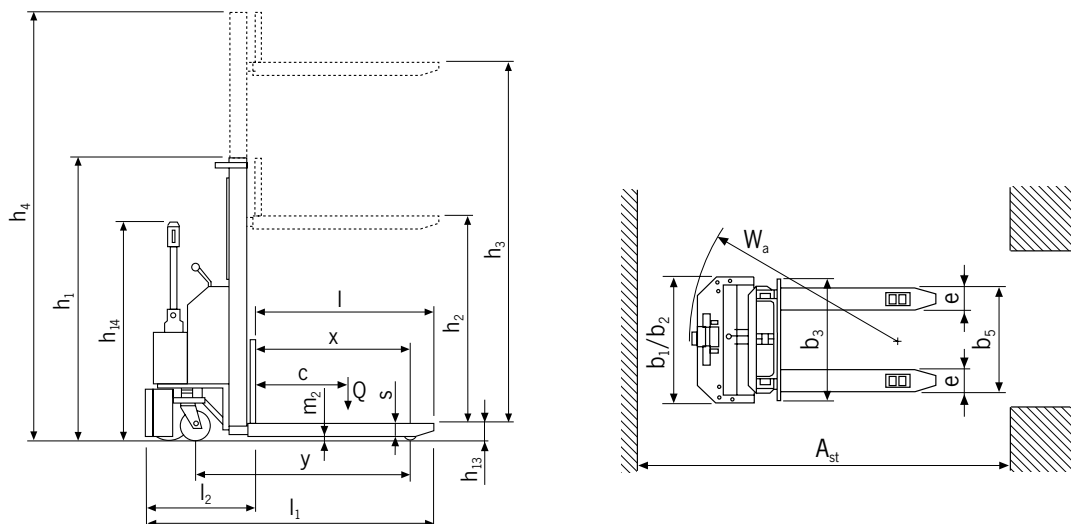

## Technical data EGV PSL II plus and EGV PSL II plus Freelift

Model	EGV PSL 1225 II plus	EGV PSL 1229 II plus	EGV PSL 1235 II plus	EGV PSL 1229 II plus Freelift
Art.-No.	192033617	192033618	192033620	192033621
Actuation	electric	electric	electric	electric
Operation	pedestrian	pedestrian	pedestrian	pedestrian
Capacity (up to 2.5 m lift), kg	1200	1200	1200	1200
Load center c, mm	600	600	600	600
Wheelbase y, mm	1234	1234	1234	1234
Weight (with battery), kg	648	663	696	693
Tyre type <sup>1</sup>	PUR/VG + PUR	PUR/VG + PUR	PUR/VG + PUR	PUR/VG + PUR
Steering rollers, mm	250 x 76 + 100 x 40	250 x 76 + 100 x 41	250 x 76 + 100 x 42	250 x 76 + 100 x 43
Load rollers, mm	82 x 70	82 x 70	82 x 70	82 x 70
Number of wheels/load rollers (x=driven)	1x + 1/2	1x + 1/2	1x + 1/2	1x + 1/2
Height, mast retracted h <sub>1</sub> , mm	1787	1987	2250	1965
Freelift h <sub>2</sub> , mm	0	0	80	1402
Stroke, mm	2410	2810	3410	2810
Height, mast extended h <sub>4</sub> , mm	2992	3392	3916	3372
Fork height max. h <sub>3</sub> , mm	2500	2900	3500	2900
Height of control handle min./max. h <sub>14</sub> , mm	915/1310	915/1310	915/1310	915/1310
Fork height lowered h <sub>13</sub> , mm	90	90	90	90
Overall length L <sub>1</sub> , mm	1760	1760	1760	1760
Length incl. apron L <sub>2</sub> , mm	609	609	609	609
Overall width b <sub>1</sub> /b <sub>2</sub> , mm	800	800	800	800
Fork height s, mm	70	70	70	70
Fork width e, mm	150	150	150	150
Fork length l, mm	1150	1150	1150	1150
Outside dimension of forks b <sub>5</sub> , mm	560	560	560	560
Ground clearance m <sub>2</sub> , mm	20	20	20	20
Aisle width pallet A <sub>st</sub> , mm	2210	2210	2210	2210
Turning circle radius W <sub>a</sub> , mm	1430	1430	1430	1430
Travel speed with/without load, km/h	4.7/5.2	4.7/5.2	4.7/5.2	4.7/5.2
Lifting speed with/without load, m/s	0.11/0.19	0.11/0.19	0.11/0.19	0.11/0.19
Lowering speed with/without load, m/s	0.19/0.19	0.19/0.19	0.19/0.19	0.16/0.14
Gradient with/without load, %	5/10	5/10	5/10	5/10
Service brake	electric	electric	electric	electric
Drive motor rating, kW	0.7	0.7	0.7	0.7
Hoist motor rating, kW	2.2	2.2	2.2	2.2
Battery	Gel	Gel	Gel	Gel
Battery charger, V/A	24/13	24/13	24/13	24/13
Battery voltage, V/Ah	24/105	24/105	24/105	24/105

<sup>1</sup>PUR... Polyurethane, VG... Solid rubber

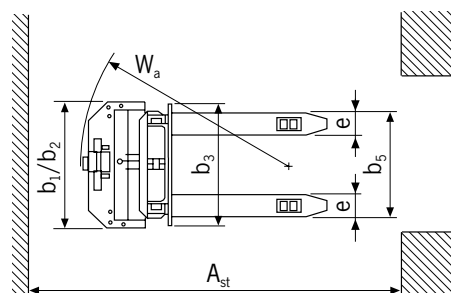
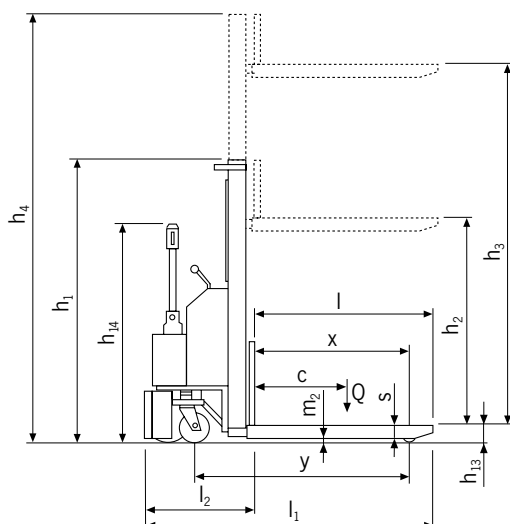

## EGV PSH II Electric pedestrian stacker

Capacity 1200 - 1600 kg,  
fork height max. 5000 mm

The revised edition of the model range EGV PSH II is the professional solution for indoor transportation and stacking of palletised loads over longer distances and higher capacity utilization.

### Features

- Multifunctional control handle with integrated drive switches and lifting and lowering functions directly on the control handle.
- Proportionally controllable lifting and lowering functions for better positioning of the loads.
- Compact overall dimensions, only 800 mm wide allows operations in narrow corridors.
- Ultra-slow drive function enables exact driving in very tight spaces.
- Drive and lifting speeds have been increased for this revised model.

### Options

- Drivers platform
- Freelift



## INFO

---

Battery and battery charger are to be ordered separately.

## Technical data EGV PSH 12 II

Model	EGV PSH 12-16 II	EGV PSH 12-25 II	EGV PSH 12-29 II	EGV PSH 12-35 II
Art.-No.	N25412161	N25412251	N25412291	N25412351
Actuation	electric	electric	electric	electric
Operation	pedestrian	pedestrian	pedestrian	pedestrian
Capacity (up to 2.5 m lift), kg	1200	1200	1200	1200
Load center c, mm	600	600	600	600
Wheelbase y, mm	1307	1307	1307	1307
Weight (with battery 180 Ah), kg	841	900	915	937
Tyre type <sup>1</sup>	PUR/VG + PUR	PUR/VG + PUR	PUR/VG + PUR	PUR/VG + PUR
Steering rollers, mm	250 x 101 + 100 x 38	250 x 101 + 100 x 38	250 x 101 + 100 x 38	250 x 101 + 100 x 38
Load rollers, mm	82 x 70	82 x 70	82 x 70	82 x 70
Number of wheels/load rollers (x=driven)	1x + 2/4	1x + 2/4	1x + 2/4	1x + 2/4
Height, mast retracted h1, mm	1965	1785	1987	2265
Freelift h2, mm	1510	-	-	80
Stroke, mm	1510	2410	2810	3410
Height, mast extended h4, mm	1965	2990	3392	3970
Fork height max. h3, mm	1600	2500	2900	3500
Height of control handle max. h14, mm	1390	1390	1390	1390
Fork height lowered h13, mm	90	90	90	90
Overall length L1, mm	1920	1920	1920	1920
Length incl. apron L2, mm	770	770	770	770
Overall width b1/b2, mm	800	800	800	800
Fork height s, mm	70	70	70	70
Fork width e, mm	150	150	150	150
Fork length l, mm	1150	1150	1150	1150
Outside dimension of forks b5, mm	560	560	560	560
Ground clearance, mm	20	20	20	20
Aisle width pallet Ast, mm	2169	2169	2169	2169
Turning circle radius Wa, mm	1550	1550	1550	1550
Travel speed with/without load, km/h	6/6	6/6	6/6	6/6
Lifting speed with/without load, m/s	0.12/0.17	0.12/0.17	0.12/0.17	0.12/0.17
Lowering speed with/without load, m/s	0.22/0.12	0.22/0.12	0.22/0.12	0.22/0.12
Gradient with/without load, %	5/10	5/10	5/10	5/10
Service brake	electric	electric	electric	electric
Drive motor rating, kW	1.2	1.2	1.2	1.2
Hoist motor rating, kW	3.2	3.2	3.2	3.2
Battery <sup>2</sup>	PzS	PzS	PzS	PzS
Battery voltage, V/Ah	24/225-300	24/225-300	24/225-300	24/225-300
Battery weight, kg	270	270	270	270
Type of control	impulse	impulse	impulse	impulse

<sup>1</sup> PUR... Polyurethane, VG... Solid rubber

<sup>2</sup> PzS... Traction battery

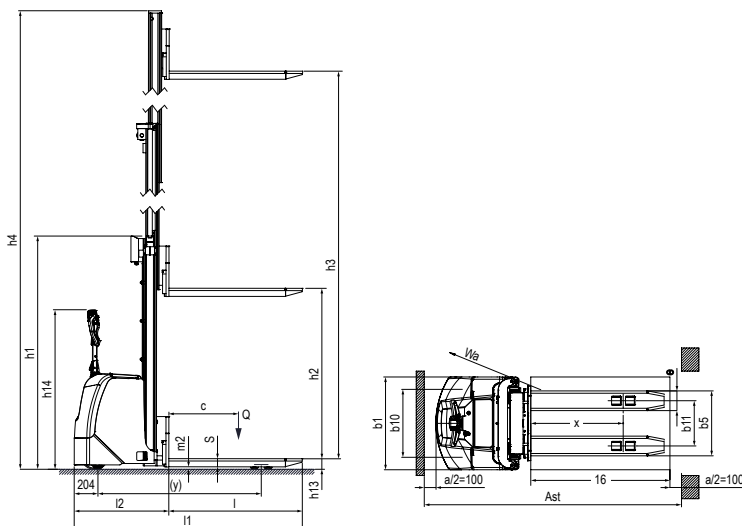



## Technical data EGV PSH 14 II

Model	EGV PSH 14-45T II	EGV PSH 14-45TF II	EGV PSH 14-50T II
Art.-No.	N25414453	N25414455	N25414503
Actuation	electric	electric	electric
Operation	pedestrian	pedestrian	pedestrian
Capacity (up to 2.5 m lift), kg	1400	1400	1400
Load center c, mm	600	600	600
Wheelbase y, mm	1370	1370	1370
Weight (with battery 180 Ah), kg	1190	1223	1229
Tyre type <sup>1</sup>	PUR/VG + PUR	PUR/VG + PUR	PUR/VG + PUR
Steering rollers, mm	250 x 101 + 100 x 38	250 x 101 + 100 x 38	250 x 101 + 100 x 38
Load rollers, mm	82 x 70	82 x 70	82 x 70
Number of wheels/load rollers (x=driven)	1x + 2/4	1x + 2/4	1x + 2/4
Height, mast retracted h1, mm	2080	2089	2285
Freelift h2, mm	-	1470	-
Stroke, mm	4410	4410	5025
Height, mast extended h4, mm	5020	5029	5635
Fork height max. h3, mm	4500	4500	5115
Height of control handle max. h14, mm	1390	1390	1390
Fork height lowered h13, mm	90	90	90
Overall length L1, mm	1966	1966	1966
Length incl. apron L2	816	816	816
Overall width b1/b2, mm	800	800	800
Fork height s, mm	70	70	70
Fork width e, mm	170	170	170
Fork length l, mm	1150	1150	1150
Outside dimension of forks b5, mm	560	560	560
Ground clearance, mm	20	20	20
Aisle width pallet Ast, mm	2389	2389	2389
Turning circle radius Wa, mm	1613	1613	1613
Travel speed with/without load, km/h	6/6	6/6	6/6
Lifting speed with/without load, m/s	0.14/0.28	0.14/0.28	0.14/0.28
Lowering speed with/without load, m/s	0.34/0.40	0.34/0.40	0.34/0.40
Gradient with/without load, %	5/10	5/10	5/10
Service brake	electric	electric	electric
Drive motor rating, kW	1.2	1.2	1.2
Hoist motor rating, kW	3.2	3.2	3.2
Battery <sup>2</sup>	PzS	PzS	PzS
Battery voltage, V/Ah	24/300 <sup>3</sup>	24/300 <sup>3</sup>	24/300 <sup>3</sup>
Battery weight, kg	270	270	270
Type of control	impulse	impulse	impulse

<sup>1</sup>PUR... Polyurethane, VG... Solid rubber

<sup>2</sup>PzS... Traction battery

<sup>3</sup>Unit only supplied with 300Ah battery

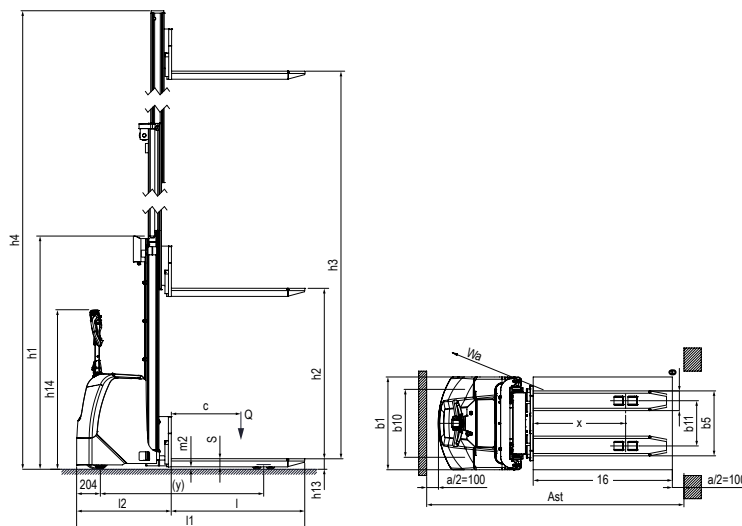

## Technical data EGV PSH 16 II

Model	EGV PSH 16-16 II	EGV PSH 16-25 II	EGV PSH 16-29 II	EGV PSH 16-35 II
Art.-No.	N25416161	N25416251	N25416291	N25416351
Actuation	electric	electric	electric	electric
Operation	pedestrian	pedestrian	pedestrian	pedestrian
Capacity (up to 2.5 m lift), kg	1600	1600	1600	1600
Load center c, mm	600	600	600	600
Wheelbase y, mm	1370	1370	1370	1370
Weight (with battery 180 Ah), kg	920	1025	1050	1090
Tyre type <sup>1</sup>	PUR/VG + PUR	PUR/VG + PUR	PUR/VG + PUR	PUR/VG + PUR
Steering rollers, mm	250 x 101 + 100 x 38	250 x 101 + 100 x 38	250 x 101 + 100 x 38	250 x 101 + 100 x 38
Load rollers, mm	82 x 70	82 x 70	82 x 70	82 x 70
Number of wheels/load rollers (x=driven)	1x + 2/4	1x + 2/4	1x + 2/4	1x + 2/4
Height, mast retracted h1, mm	1965	1765	1965	2265
Freelift h2, mm	1510	-	-	-
Stroke, mm	1510	2410	2810	3410
Height, mast extended h4, mm	1965	2970	3370	3970
Fork height max. h3, mm	1600	2500	2900	3500
Height of control handle max. h14, mm	1390	1390	1390	1390
Fork height lowered h13, mm	90	90	90	90
Overall length L1, mm	1944	1944	1944	1944
Length incl. apron L2, mm	795	795	795	795
Overall width b1/b2, mm	800	800	800	800
Fork height s, mm	70	70	70	70
Fork width e, mm	170	170	170	170
Fork length l, mm	1150	1150	1150	1150
Outside dimension of forks b5, mm	560	560	560	560
Ground clearance, mm	20	20	20	20
Aisle width pallet Ast, mm	2195	2195	2195	2195
Turning circle radius Wa, mm	1613	1613	1613	1613
Travel speed with/without load, km/h	6/6	6/6	6/6	6/6
Lifting speed with/without load, m/s	0.13/0.25	0.13/0.25	0.13/0.25	0.13/0.25
Lowering speed with/without load, m/s	0.31/0.38	0.31/0.38	0.31/0.38	0.31/0.38
Gradient with/without load, %	5/10	5/10	5/10	5/10
Service brake	electric	electric	electric	electric
Drive motor rating, kW	1.2	1.2	1.2	1.2
Hoist motor rating, kW	3.2	3.2	3.2	3.2
Battery <sup>2</sup>	PzS	PzS	PzS	PzS
Battery voltage, V/Ah	24/225-300	24/225-300	24/225-300	24/225-300
Battery weight, kg	270	270	270	270
Type of control	impulse	impulse	impulse	impulse

<sup>1</sup> PUR... Polyurethane, VG... Solid rubber

<sup>2</sup> PzS... Traction battery

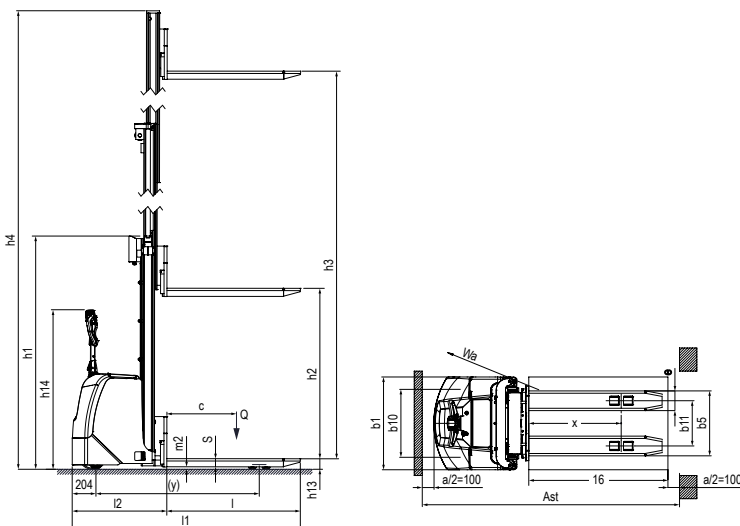

*The Hand pallet trucks  
of the new generation of batteries  
you will find  
on pages 288-293*



HU 12-115 TP **Li-ION**



EGU 15 E **Li-ION**



EGU PS 14 **Li-ION**

### **Li-ION** battery

---

This battery offers much longer operational periods and overall lifetime of the battery with shorter charges.

- The Li-ION battery has a lifespan of up to 3000 charging cycles.
- Charging time of only 2.5 hours.
- Intermediate charge is possible without affecting the lifetime of the battery.
- No loss of power when the battery charge state drops.

## PRAKTIKUS HP Platformlift, mobile

Capacity 400 kg,  
 platform height max. 1200 mm

For the occasional, internal application of lifting and transporting of goods.

### Features

- Easy lifting by tiltable foot pedal.
- Lowering speed can be finely metered for sensitive lowering of the load.
- Ergonomic handlebar for easy operation.
- Steering roller with brake for safe parking of the hand stacker.
- Robust construction with chrome plated chassis, hard chromium plated piston and pressure relief valve.
- Covered chain deflection for increased safety.



### Technical data PRAKTIKUS HP

Model	HP 0412
Art.-No.	40008779
Capacity, kg	400
Platform height max. $h_3 + h_{13}$ , mm	1200
Platform height min. $h_{13}$ , mm	200
Freelift $h_2$ , mm	1000
Stroke $h_3$ , mm	1000
Lifting height per pump stroke, mm	23
Overall height $h_1$ , mm	1310
Overall length $L_1$ , mm	1037
Overall width $b_1$ , mm	590
Platform length $P_1$ , mm	650
Platform width $P_2$ , mm	550
Tyre type <sup>1</sup>	VG/VG
Steering rollers, mm	150 x 45
Load rollers, mm	150 x 45
Number of wheels/load rollers	2/2
Ground clearance $m_1$ , mm	50
Wheelbase $y$ , mm	785
Weight, kg	71

<sup>1</sup> VG... Solid rubber

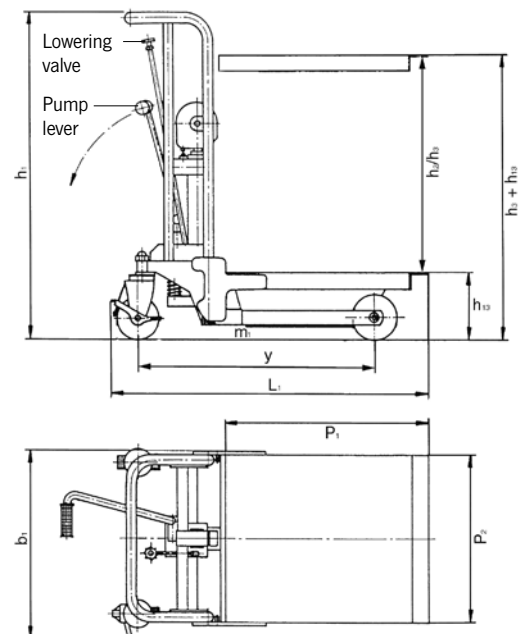



HX 150

## HX Scissor elevating platform, mobile with single scissor

Capacity 150 - 750 kg,  
platform height max. 1000 mm

For the independant lifting and supplying of loads within a warehouse environment.

### Features

- Hydraulic lifting of the load with foot pedal.
- Lowering speed can be finely metered for sensitive lowering of the load.
- Ergonomic handlebar for easy operation, tiltable for model HX 150.
- Steering roller with brake for safe parking of the hand stacker.
- Robust construction with hard chromium plated piston and pressure relief valve.

### Technical data HX

Model	HX 150	HX 300	HX 500	HX 750
Art.-No.	34600020	40057357	40057358	40057360
Capacity, kg	150	300	500	750
Platform height max. $h_3 + h_{13}$ , mm	720	880	880	1000
Platform height min. $h_{13}$ , mm	220	285	285	420
Stroke $h_3$ , mm	500	595	595	580
Lifting height per pump stroke, mm	27	31	31	15
Overall height $h_1$ , mm	960	984	984	990
Overall length $L_1$ , mm	908	1093	1093	1330
Overall width $b_1$ , mm	450	500	500	600
Platform length $P_1$ , mm	700	850	850	1000
Platform width $P_2$ , mm	450	500	500	510
Tyre type <sup>1</sup>	PUR/PUR	PUR/PUR	PUR/PUR	PUR/PUR
Rollers, mm	100 x 36	128 x 40	128 x 40	147 x 50
Number of wheels/load rollers	2/2	2/2	2/2	2/2
Weight, kg	49	78	82	120

<sup>1</sup>PUR... Polyurethane

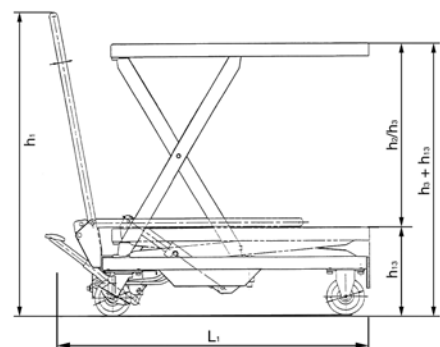
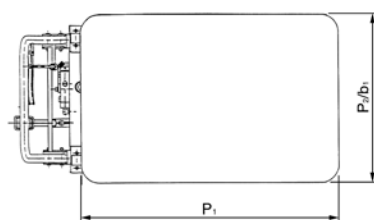

## HX-D Scissor elevating platform, mobile with double scissor

Capacity 350 kg,  
platform height max. 1300 mm

For the independant lifting and supplying of light up to medium loads within a warehouse environment.

### Features

- Hydraulic lifting of the load with foot pedal.
- Lowering speed can be finely metered for sensitive lowering of the load.
- Ergonomic handlebar for easy operation.
- Steering roller with brake for safe parking of the hand stacker.
- Robust construction with hard chromium plated piston and pressure relief valve.
- According to EN 1570, prEN 1757-4.



### Technical data HX-D

Model	HX-D 350
Art.-No.	40057361
Capacity, kg	350
Platform height max. $h_3 + h_{13}$ , mm	1300
Platform height min. $h_{13}$ , mm	370
Stroke $h_3$ , mm	930
Lifting height per pump stroke, mm	21
Overall height $h_1$ , mm	965
Overall length $L_1$ , mm	1140
Overall width $b_1$ , mm	500
Platform length $P_1$ , mm	910
Platform width $P_2$ , mm	500
Tyre type <sup>1</sup>	PUR/PUR
Load rollers, mm	128 x 40
Number of wheels/load rollers	2/2
Weight, kg	136

<sup>1</sup>PUR... Polyurethane

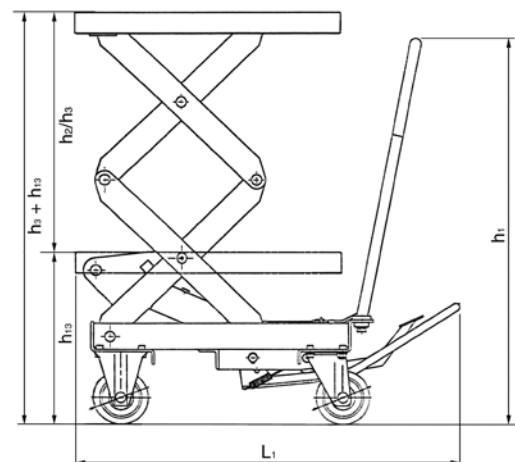
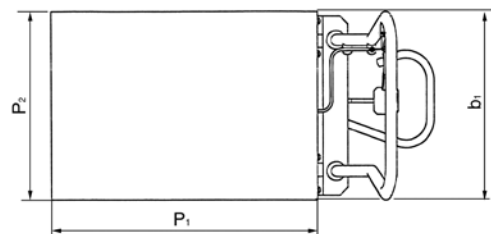



### HF...SM

Scissor elevating platform,  
mobile with single scissor and  
- manual hydraulic

Capacity 150 - 1250 kg,  
platform height max. 1050 mm

### HF...SE

- electric hydraulic system

Capacity 300 - 1250 kg,  
platform height max. 1050 mm

For lifting and supplying goods independent of the  
location.

#### Features

- Manual hydraulic system with pedal or electric hydraulic system with dead man function – a main current connection is not required.
- High safety due to pressure relief and lowering valve.
- Robust single scissor construction, above 300 kg with solid steer scissor.
- Pivoting platform with mechanic adjustment for safe maintenance work.
- Compact design with low OAH.
- Steering and fixed rollers with service-free roller bearings. One steer roller can be locked in position for parking.
- According to EN 1570 and machinery directive 2006/42/EG.



#### Scope of delivery

- Models with electric-hydraulic pump are supplied complete with battery and charger.



## Technical data HF/SM

Model	HF 015-078 SM	HF 030-084 SM	HF 050-090 SM	HF 080-105 SM	HF 100-105 SM	HF 125-105 SM
Art.-No.	N24501078	N24503084	N24505090	N24508105	N24510105	N24512105
Capacity, kg	150	300	500	800	1000	1250
Platform height max. $h_2$ , mm	780	840	900	1050	1050	1050
Platform height min. $h_1$ , mm	255	335	340	360	360	360
Stroke $h_3$ , mm	525	505	560	690	690	690
Overall length $l_1$ , mm	990	1050	1320	1650	2350	1650
Overall width $b_1$ , mm	450	500	610	860	1000	860
Platform length $l$ , mm	760	840	1030	1350	2000	1350
Platform width $b_1$ , mm	450	500	610	840	1000	840
Tyre type <sup>1</sup>	VG	PUR	PUR	PA	PA	PA
Service brake	manual	manual	manual	manual	manual	manual
Number of strokes for max. lift	14	18	29	40	80	80
Weight (with battery and battery charger), kg	41	83	109	222	286	230

<sup>1</sup>PA... Polyamide, PUR... Polyurethane, VG... Solid rubber

## Technical data HF/SE

Model	HF 030-084 SE	HF 050-090 SE	HF 080-105 SE	HF 100-105 SE	HF 125-105 SE
Art.-No.	N24603084	N24605090	N24608105	N24610105	N24612105
Capacity, kg	300	500	800	1000	1250
Platform height max. $h_2$ , mm	840	900	1050	1050	1050
Platform height min. $h_1$ , mm	335	340	360	360	360
Stroke $h_3$ , mm	505	560	690	690	690
Overall length $l_1$ , mm	1130	1330	1650	2350	1650
Overall width $b_1$ , mm	500	610	860	1000	860
Platform length $l$ , mm	840	1030	1350	2000	1350
Platform width $b_1$ , mm	500	610	840	1000	840
Tyre type <sup>1</sup>	PUR	PUR	PA	PA	PA
Service brake	manual	manual	manual	manual	manual
Number of strokes for max. lift	electric	electric	electric	electric	electric
Weight (with battery and battery charger), kg	120	158	270	397	278

<sup>1</sup>PA... Polyamide, PUR... Polyurethane

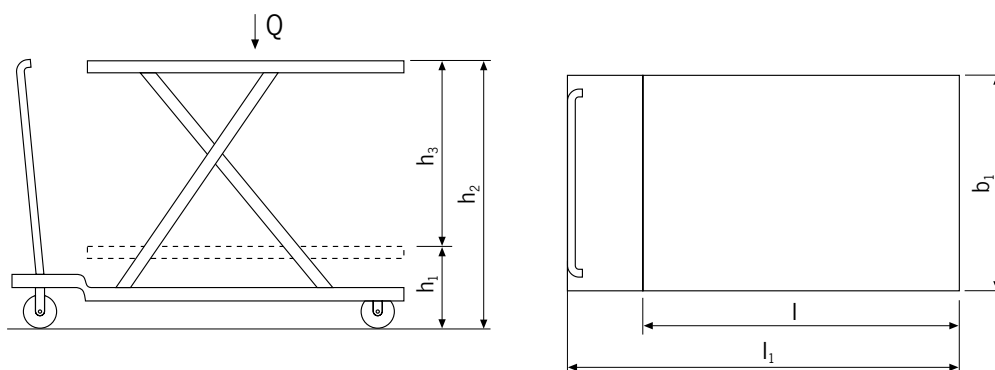



### HF...DM

Scissor elevating platform,  
mobile with double vertical  
scissor and  
- manual hydraulic

### HF...DE

- electric hydraulic system

Capacity 125 - 800 kg,  
platform height max. 1900 mm

For lifting and supplying goods independent of the  
location.

#### Features

- Manual hydraulic system with pedal or electric hydraulic system with dead man function – a main current connection is not required.
- High safety due to pressure relief and lowering valve.
- Robust single scissor construction, above 300 kg with solid steer scissor.
- Pivoting platform with mechanic adjustment for safe maintenance work.
- Compact design with low OAH.
- Steering and fixed rollers with service-free roller bearings. One steer roller can be locked in position for parking.
- According to EN 1570 and machinery directive 2006/42/EG.



#### Scope of delivery

- Models with electric-hydraulic pump are supplied complete with battery and charger.

## Technical data HF/DM

Model	HF 012-142 DM	HF 045-155 DM	HF 050-190 DM	HF 080-190 DM
Art.-No.	N24701142	N24704155	N24705190	N24708190
Capacity, kg	125	450	500	800
Platform height max. $h_2$ , mm	1420	1550	1900	1900
Platform height min. $h_1$ , mm	430	295	490	490
Stroke $h_3$ , mm	990	1255	1410	1410
Overall length $l_1$ , mm	1090	1350	1650	1650
Overall width $b_1$ , mm	500	665	860	860
Platform length $l$ , mm	840	1030	1350	1350
Platform width $b_1$ , mm	500	610	840	840
Tyre type <sup>1</sup>	PUR	PUR	PA	PA
Service brake	manual	manual	manual	manual
Number of strokes for max. lift	19	71	80	160
Weight (with battery and battery charger), kg	100	143	306	315

<sup>1</sup>PA... Polyamide, PUR... Polyurethane

## Technical data HF/DE

Model	HF 012-142 DE	HF 045-155 DE	HF 050-190 DE	HF 080-190 DE
Art.-No.	N24801142	N24804155	N24805190	N24808190
Capacity, kg	125	450	500	800
Platform height max. $h_2$ , mm	1420	1550	1900	1900
Platform height min. $h_1$ , mm	430	295	490	490
Stroke $h_3$ , mm	990	1255	1410	1410
Overall length $l_1$ , mm	1090	1350	1650	1650
Overall width $b_1$ , mm	500	665	860	860
Platform length $l$ , mm	840	1030	1350	1350
Platform width $b_1$ , mm	500	610	840	840
Tyre type <sup>1</sup>	PUR	PUR	PA	PA
Service brake	manual	manual	manual	manual
Number of strokes for max. lift	electric	electric	electric	electric
Weight (with battery and battery charger), kg	147	190	352	363

<sup>1</sup>PA... Polyamide, PUR... Polyurethane

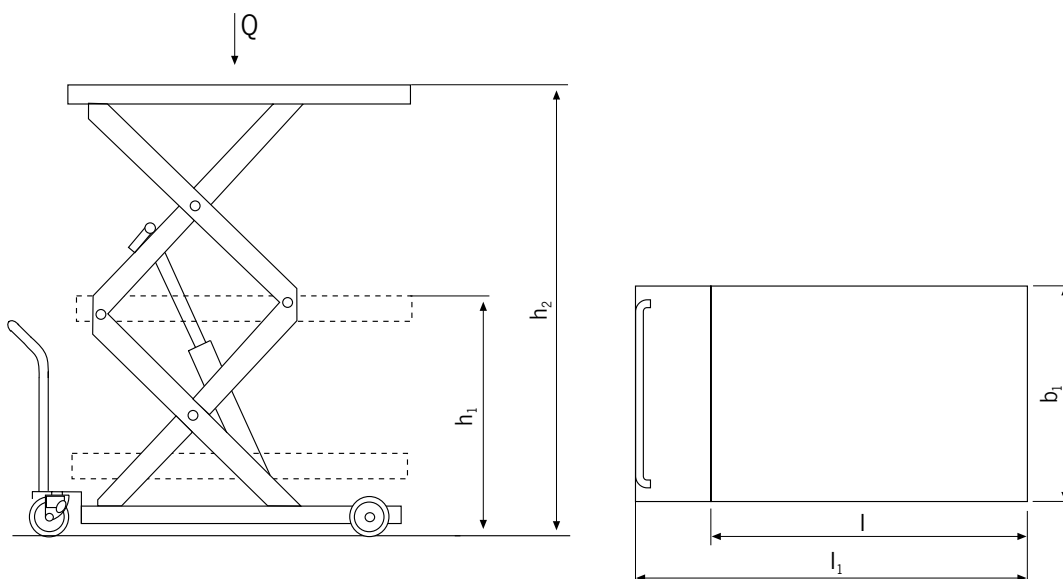



**HT 08 M**

Mobile elevating work bench with  
- manual-hydraulic lift

**HT 08 E**

Mobile elevating work bench with  
- electric-hydraulic lift

Capacity 800 kg,  
platform height max. 1475 mm

For lifting and transporting of heavy loads in manufacturing and assembly processes.

**Features**

- Triplex mast for lifting heights up to 1475 mm
- Ergonomic handlebar for easy operation.
- Double-acting hand pump with increased lift per handle stroke (HT 08 M).
- Electric hydraulic unit with battery for comfortable and easy lifting (HT 08 E).
- Steering roller with brake for safe parking of the hand stacker.
- Robust construction with hard chromium plated piston.

**Scope of delivery HT 08 E**

- Battery and integrated battery charger.

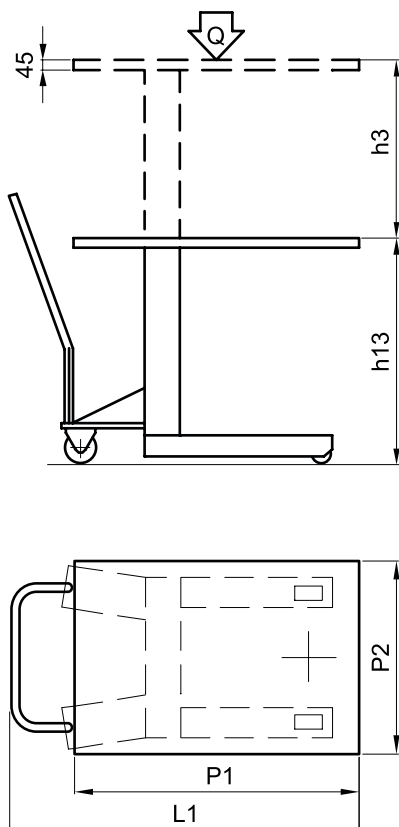

**Technical data HT 08 M and HT 08 E**

Model	HT 08 M	HT 08 E
Art.-No.	N24380120	N24380129
Capacity, kg	800	800
Platform height max. h3 + h13, mm	1475	1475
Platform height min. h13, mm	700	700
Stroke h3, mm	775	775
Overall length L1, mm	980	980
Platform length P1, mm	800	800
Platform width P2, mm	750	750
Tyre type <sup>1</sup>	PUR/PUR	PUR/PUR
Brake	manual	manual
Lifting height per pump stroke, mm	12.5	-
Lifting speed with/without load, m/s	-	0.08/0.125
Hoist motor rating, kW	-	0.8
Battery voltage, V/Ah	-	12/100
Battery charger, V/A	-	12/10
Weight, kg	134	152
Battery weight, kg	-	25

<sup>1</sup>PUR... Polyurethane

## HTF-G SILVERLINE Flat scissor lifting table

Capacity 1000 kg

For the professional lifting and handling of loads within a warehouse environment.

### Features

- Extremely low-profile design reducing cost and effort for a pit-installation.
- The ramp allows loading the platform directly with a pallet truck or trolley.
- Safe operation due to push-button for up/down in dead man's control, as well as emergency stop.
- Overload protection by pressure control valve.
- Integrated pipe burst valve and mechanical rests safe maintenance and operation.
- According to EN 1570-1 and all UVV safety regulations.



### Technical data HTF-G

Model	HTF-G
Art.-No.	40047380
Capacity, kg	1000
Platform length L, m	1.45
Platform width B, m	1.14
Platform height min. C, mm	82
Lift H, m	0.76
Lifting time, sec.	18
Motor, kW	0.75
Weight, kg	250

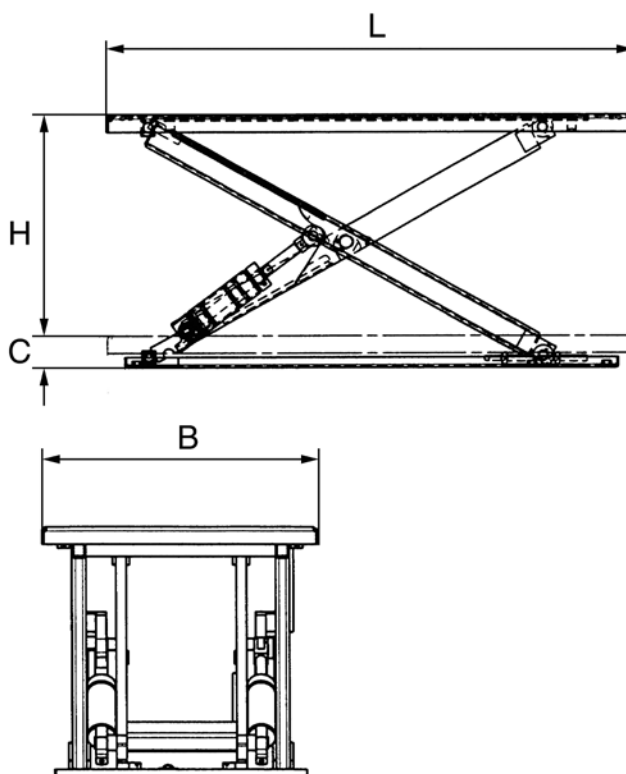

## HTF-U SILVERLINE Flat scissor lifting table

Capacity 1000 kg

For the professional lifting and handling of loads within a warehouse environment.

### Features

- Extremely low-profile design lowering the cost and effort for a pit installation.
- U-design for direct access of industrial trucks.
- Safe operation due to push-button for up/down in dead man's control, as well as emergency stop.
- Overload protection by pressure control valve.
- Integrated pipe burst valve and mechanical rests safe maintenance and operation.
- According to EN 1570-1 and all UVV safety regulations.

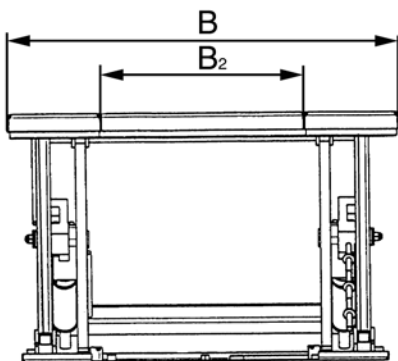
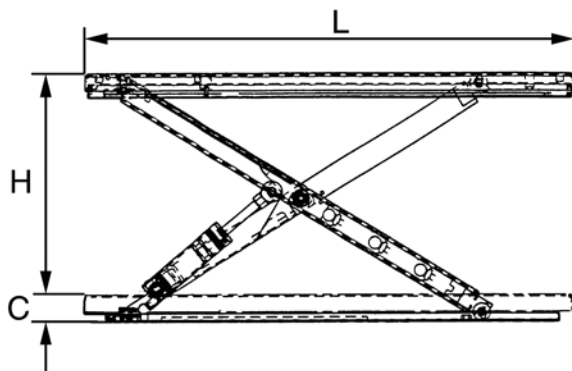

### Technical data HTF-U SILVERLINE

Model	HTF-U
Art.-No.	40047381
Capacity, kg	1000
Platform B2, mm	585
Platform length L, m	1.45
Platform width B, m	1.14
Platform height min. C, mm	80
Lift H, m	0.76
Lifting time, sec.	18
Motor, kW	0.75
Weight, kg	235

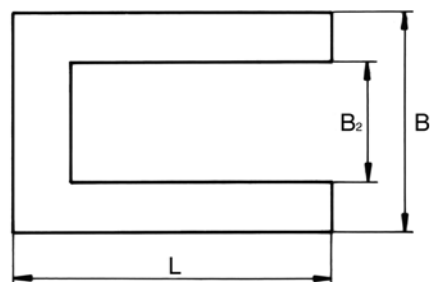

## HTH-E SILVERLINE Handling table

Capacity 500 - 3000 kg

For the professional lifting and handling of heavy loads and palletised goods at workplaces

### Features

- Smooth hydraulic ram action of working height for ergonomic working conditions.
- Safe operation due to push-button for up/down in dead man's control, as well as emergency stop.
- Overload protection by pressure control valve.
- Integrated pipe burst valve and mechanical rests safe maintenance and operation.
- According to EN 1570-1 and all UVV safety regulations.



### Technical data HTH-E SILVERLINE

Model	HTH-E	HTH-E	HTH-E	HTH-E
Art.-No.	40049470	40049471	40049472	40049473
Capacity, kg	500	1000	2000	3000
Platform length L, m	1.3	1.3	1.3	1.3
Platform width B, m	0.8	0.8	0.8	0.8
Platform height min. C, mm	190	190	190	220
Lift H, m	0,82	0,82	0,82	0,80
Lifting time, sec.	15.0	25	40	26
Motor, kW	0.75	0.75	0.75	1.50
Weight, kg	160	220	280	320

